

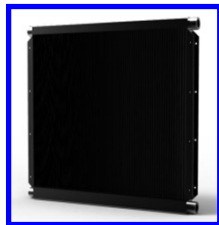

# FAN COOLER



주식회사 플루마

Fluma Co., Ltd.

HYDRAULIC, PNEUMATIC AND ELECTRIC TECHNOLOGY

# FAN COOLER ORDER DESIGNATION

## FAN COOLER 주문코드

**AFA** - **2** - **A** - **430**

1                      2                      3                      4

1	FAN COOLER TYPE FAN COOLER 타입
2	MATRIX QUANTITY MATRIX 수량
3	SPECIFICATION OF MOTOR 모터 사양
4	VERTICAL DEMISSION OF OIL IN/OUT PORT 오일 입/출구 간 수직 거리

◀ AFA SERIES = AC MOTOR FAN COOLER SERIES  
 AFD SERIES = DC MOTOR FAN COOLER SERIES  
 AFH SERIES = HYDAULIC MOTOR FAN COOLER SERIES

◀ - = 1 EA  
 2 = 2 EA

◀ A = AC 220V / 380V, 60Hz  
 B = AC 220V 50/60Hz  
 C =  
 D = DC 24V  
 E = DC 12V  
 F =  
 G =  
 H = HYDRAULIC

◀ PLEASE REFER DETAIL SPECIFICATION OF FAN COOLER.  
 FAN COOLER의 자세한 사양 참조 바랍니다.

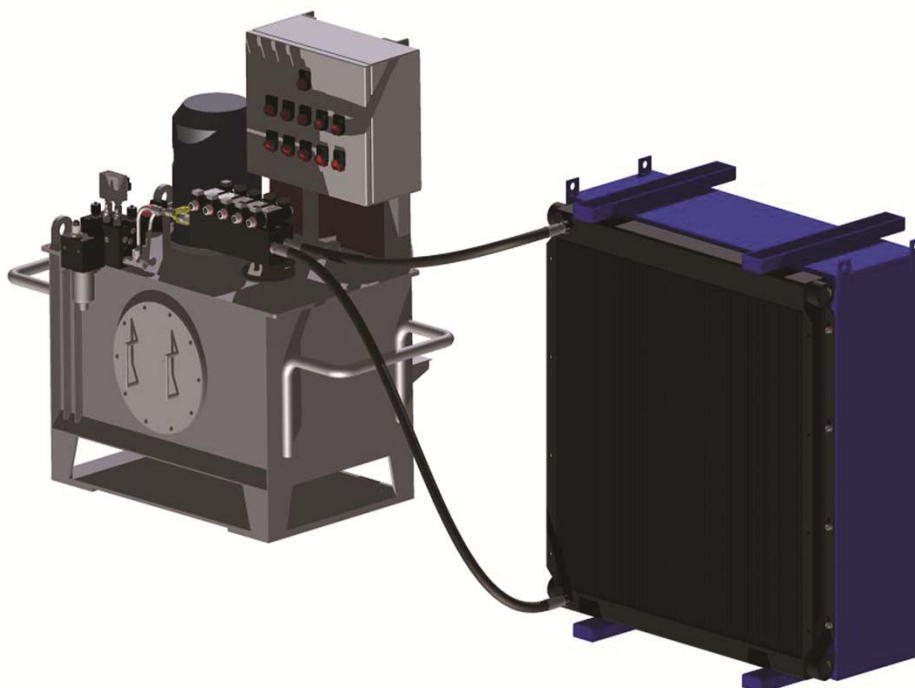

AC MOTOR FAN COOLER – DIMENSION  
AC MOTOR FAN COOLER – 치수

AFA - - - 260

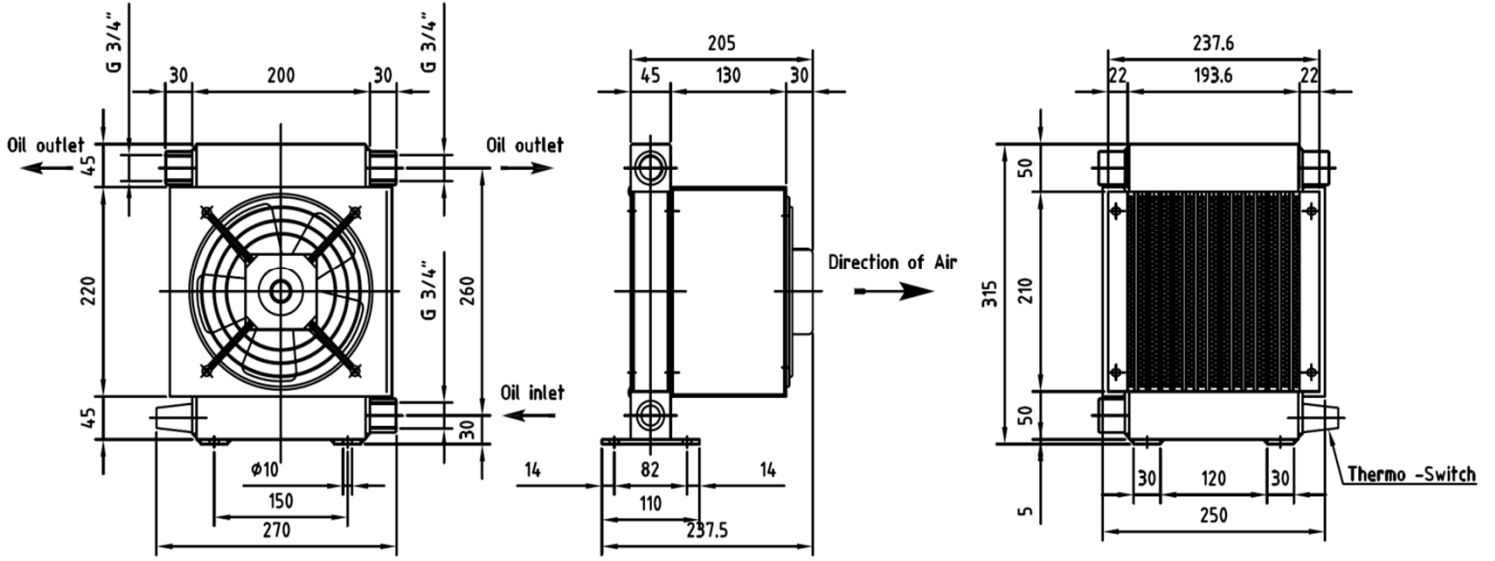

오일 유량 OIL FLOW	오일 체적 OIL CAPACITY	전압 VOLTAGE	모터 MOTOR	전류 FREQUENCY	전류 CURRENT	풍량 AIR FLOW	보호등급 PROTECTION	소음 정도 NOISE LEVEL	중량 WEIGHT	최대사용압력* PRESSURE RANGE*
l/min	l	V	W	Hz	A	m <sup>3</sup> /hr	IP	dB(A)	Kg	bar
5 ~ 60	1.2	220 / 380	100	60	0.46 / 0.28	700	55	70	6	20
		380		60	0.23					

\* 최대사용압력은 동압 기준임.  
\* Pressure range is based on dynamic pressure.

PERFORMANCE DIAGRAM  
성능 곡선 표

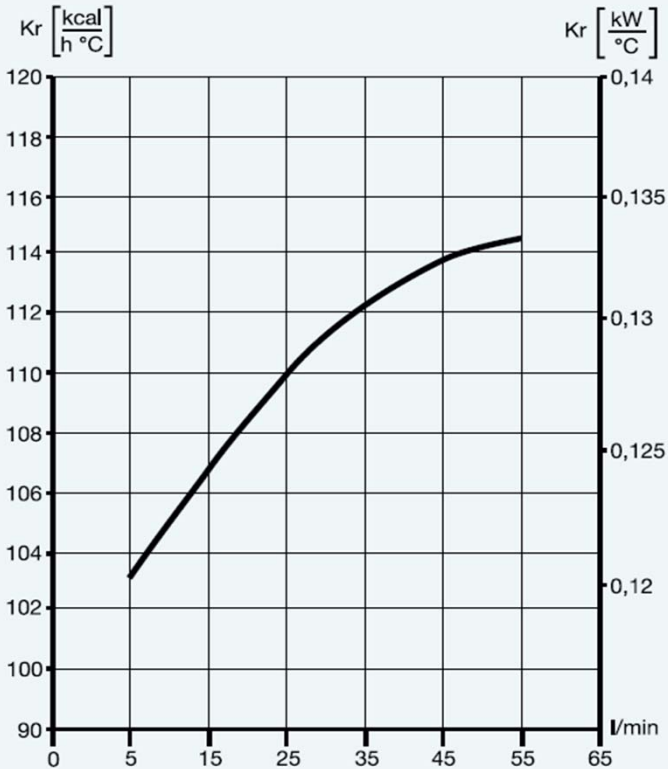

LOSS OF PRESSURE DIAGRAM  
차압 곡선 표

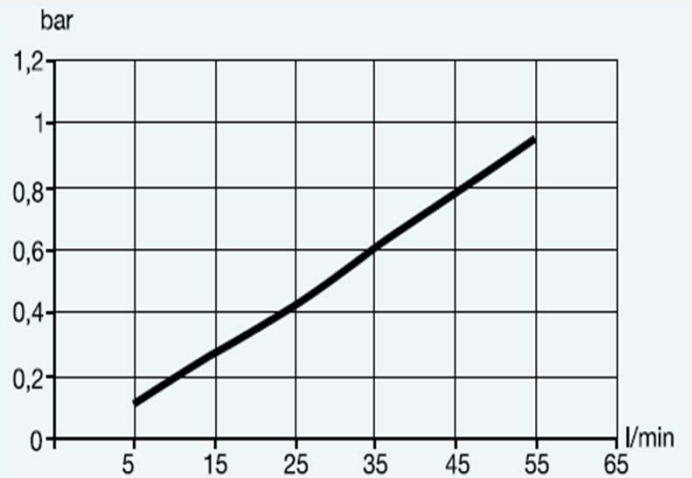

CORRECTION FACTOR  
보정 계수

cSt	22	30	46	68	100	150	220
f	0.6	1	1.5	2.3	3.5	5	7

AC MOTOR FAN COOLER – DIMENSION  
AC MOTOR FAN COOLER – 치수

AFA - - - 300

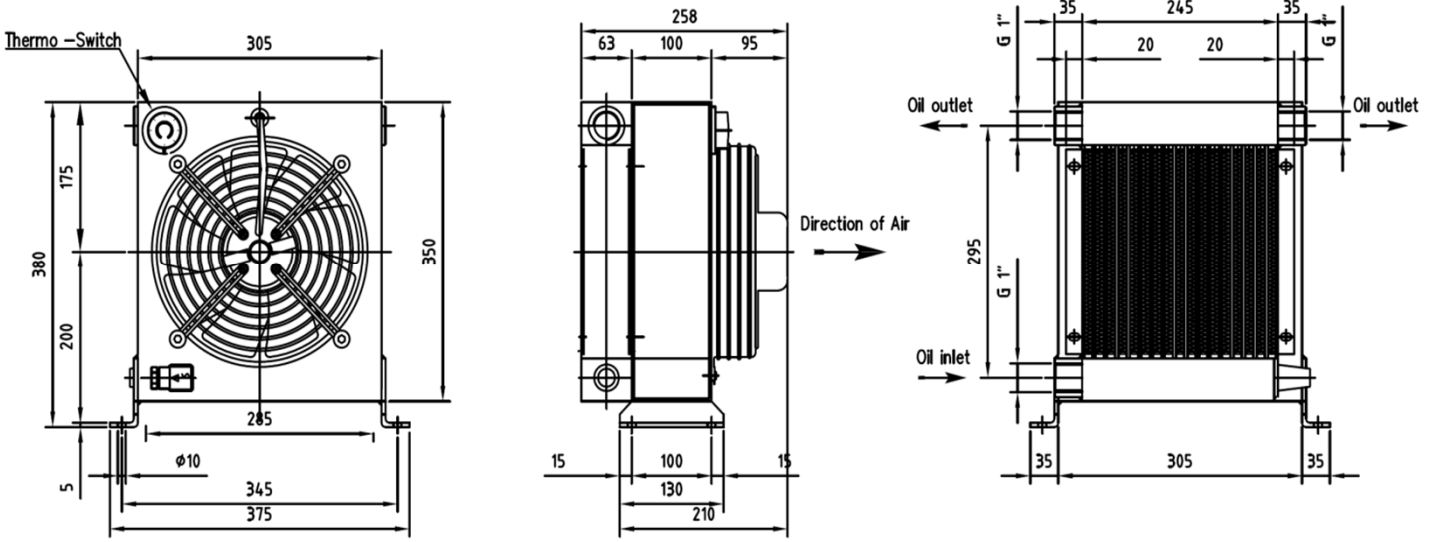

오일 유량 OIL FLOW	오일 체적 OIL CAPACITY	전압 VOLTAGE	모터 MOTOR	전류 FREQUENCY	전류 CURRENT	풍량 AIR FLOW	보호 등급 PROTECTION	소음 정도 NOISE LEVEL	중량 WEIGHT	최대사용압력* PRESSURE RANGE*
l/min	l	V	W	Hz	A	m <sup>3</sup> /hr	IP	dB(A)	Kg	bar
10 ~ 80	2	220 / 380	110	60	0.5 / 0.3	1,000	55	72	12	20
		380		60						

\* 최대사용압력은 동압 기준임.  
\* Pressure range is based on dynamic pressure.

PERFORMANCE DIAGRAM  
성능 곡선 표

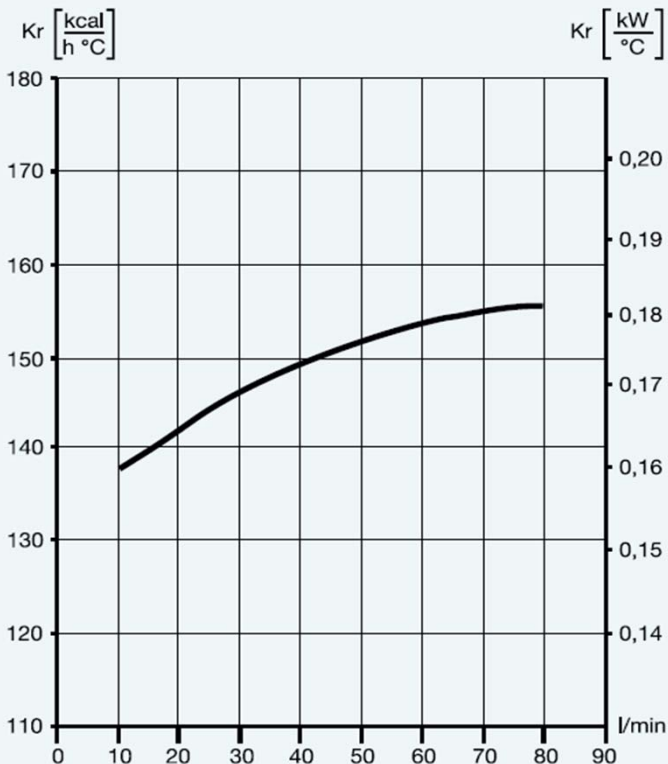

LOSS OF PRESSURE DIAGRAM  
차압 곡선 표

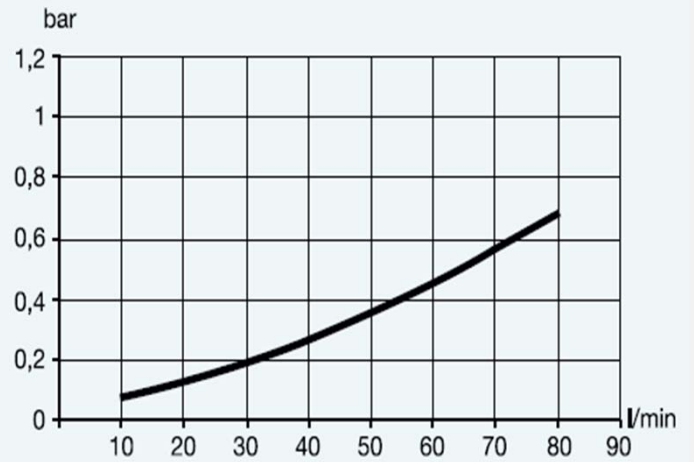

CORRECTION FACTOR  
보정 계수

cSt	22	30	46	68	100	150	220
f	0.6	1	1.5	2.3	3.5	5	7

AC MOTOR FAN COOLER – DIMENSION  
AC MOTOR FAN COOLER – 치수

AFA - - - 300/2

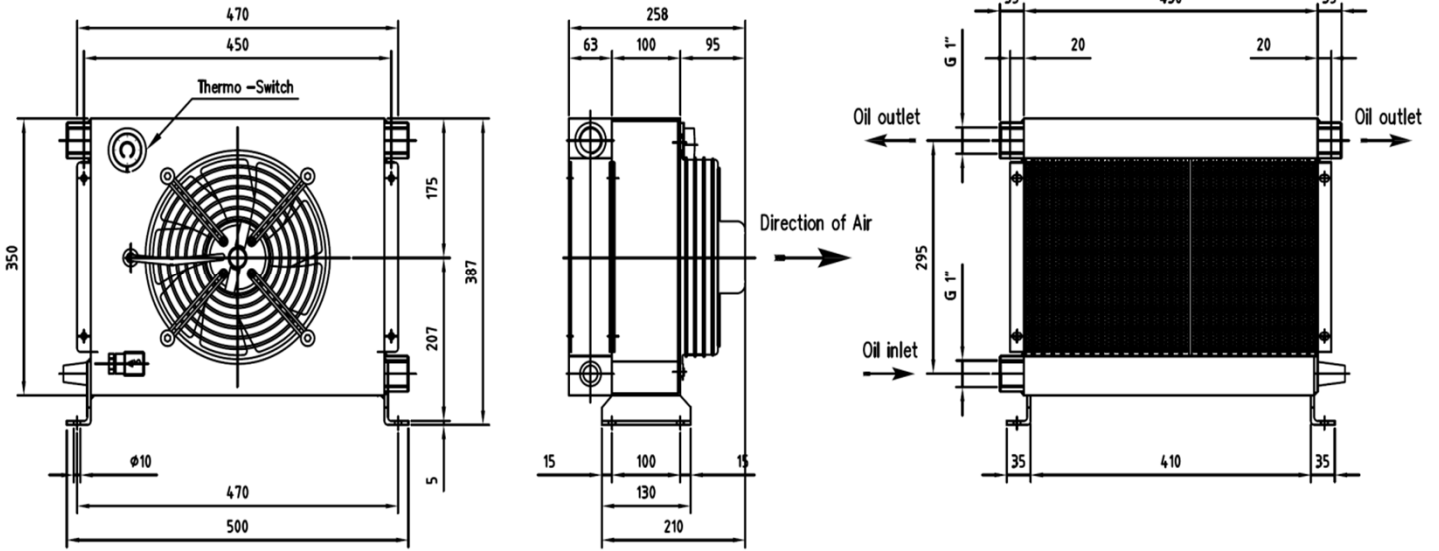

오일 유량 OIL FLOW	오일 체적 OIL CAPACITY	전압 VOLTAGE	모터 MOTOR	전류 FREQUENCY	전류 CURRENT	풍량 AIR FLOW	보호 등급 PROTECTION	소음 정도 NOISE LEVEL	중량 WEIGHT	최대사용압력* PRESSURE RANGE*
l/min	l	V	W	Hz	A	m <sup>3</sup> /hr	IP	dB(A)	Kg	bar
20 ~ 150	3.6	220 / 380	130	60	0.6 / 0.35	1,300	55	73	17	20
		380		60	0.3					

\* 최대사용압력은 동압 기준임.  
\* Pressure range is based on dynamic pressure.

PERFORMANCE DIAGRAM  
성능 곡선 표

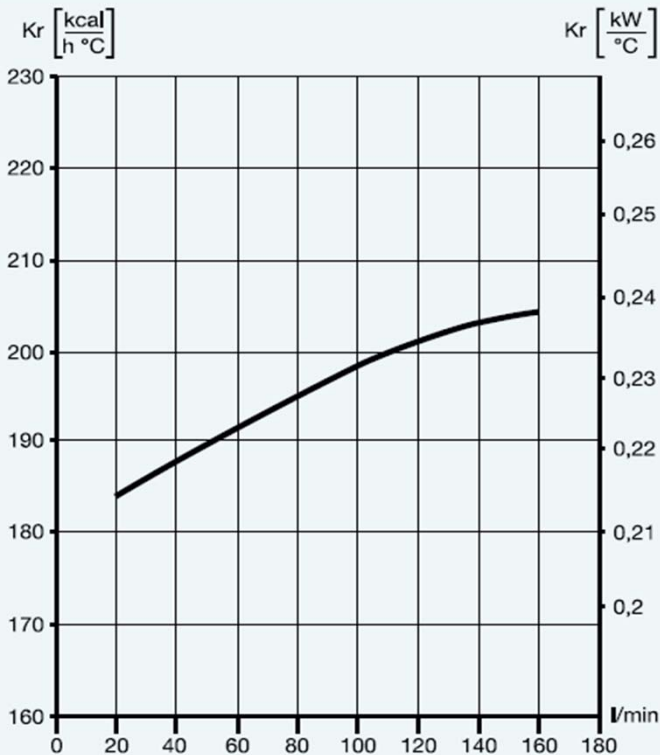

LOSS OF PRESSURE DIAGRAM  
차압 곡선 표

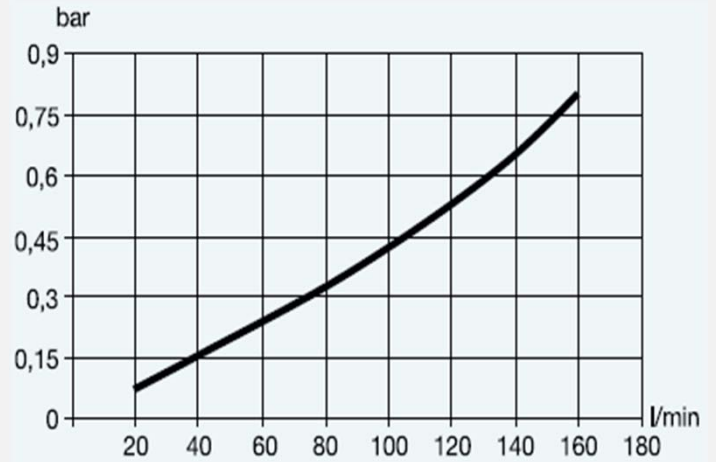

CORRECTION FACTOR  
보정 계수

cSt	22	30	46	68	100	150	220
f	0.6	1	1.5	2.3	3.5	5	7

AC MOTOR FAN COOLER – DIMENSION  
AC MOTOR FAN COOLER – 치수

AFA - - - 430

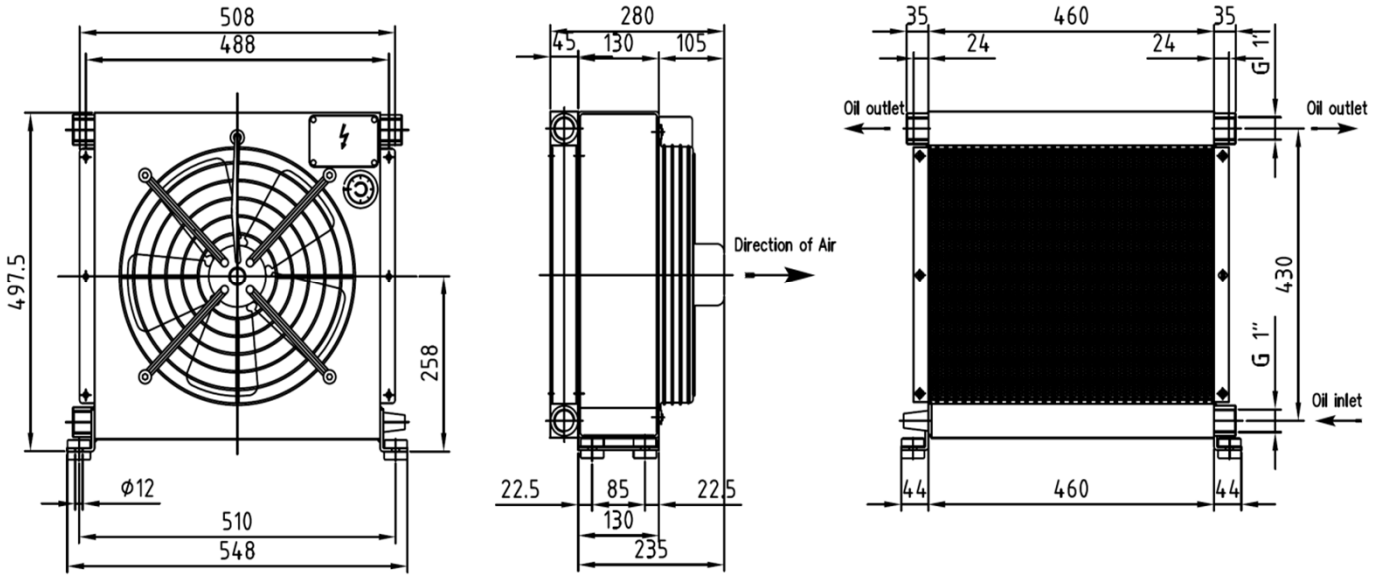

오일 유량 OIL FLOW	오일 체적 OIL CAPACITY	전압 VOLTAGE	모터 MOTOR	전류 FREQUENCY	전류 CURRENT	풍량 AIR FLOW	보호 등급 PROTECTION	소음 정도 NOISE LEVEL	중량 WEIGHT	최대사용압력* PRESSURE RANGE*
l/min	l	V	W	Hz	A	m <sup>3</sup> /hr	IP	dB(A)	Kg	bar
30 ~ 150	3.6	220 / 380	220	60	1.1 / 0.6	3,000	55	75	18	20
		380		60	0.5					

\* 최대사용압력은 동압 기준임.  
\* Pressure range is based on dynamic pressure.

PERFORMANCE DIAGRAM  
성능 곡선 표

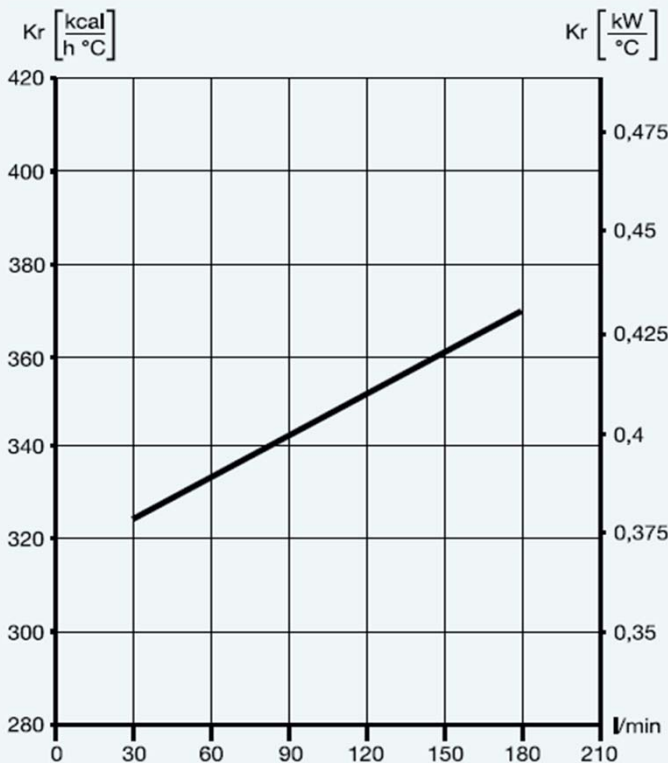

LOSS OF PRESSURE DIAGRAM  
차압 곡선 표

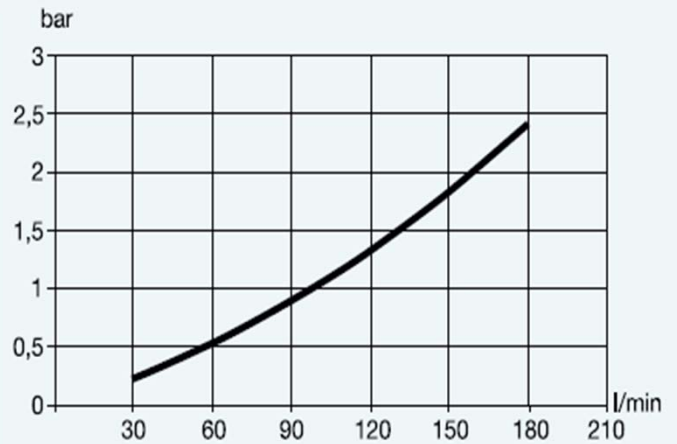

CORRECTION FACTOR  
보정 계수

cSt	22	30	46	68	100	150	220
f	0.6	1	1.5	2.3	3.5	5	7

AC MOTOR FAN COOLER – DIMENSION  
AC MOTOR FAN COOLER – 치수

AFA - - - 430/2

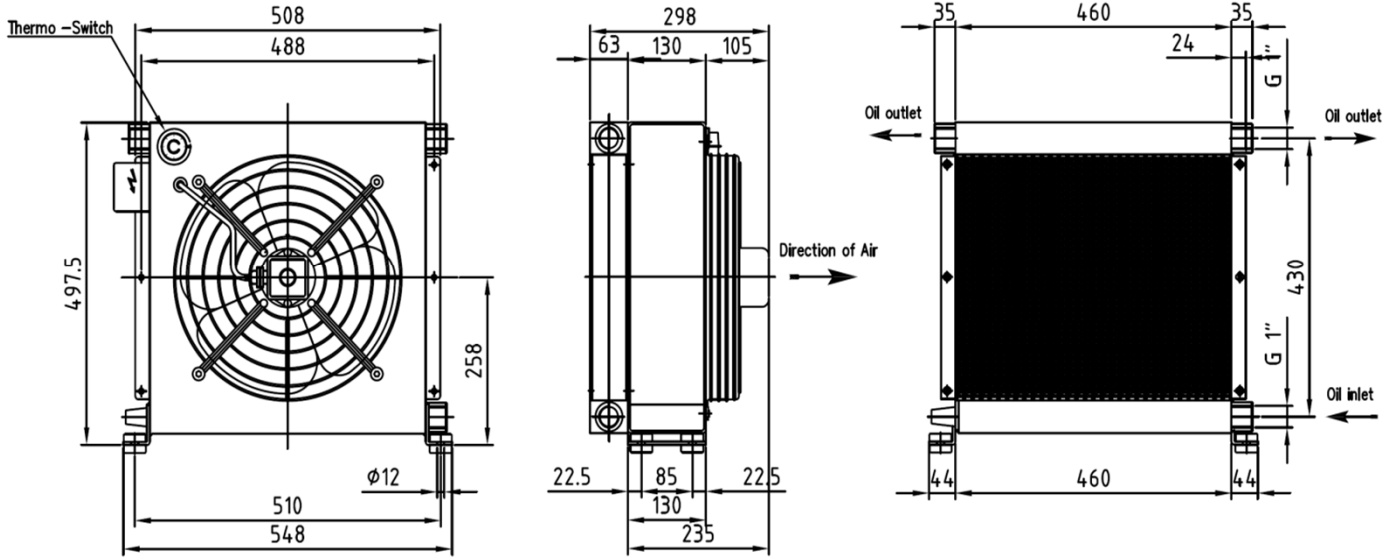

오일 유량 OIL FLOW	오일 체적 OIL CAPACITY	전압 VOLTAGE	모터 MOTOR	전류 FREQUENCY	전류 CURRENT	풍량 AIR FLOW	보호 등급 PROTECTION	소음 정도 NOISE LEVEL	중량 WEIGHT	최대사용압력* PRESSURE RANGE*
l/min	l	V	W	Hz	A	m <sup>3</sup> /hr	IP	dB(A)	Kg	bar
30 ~ 180	5.5	220 / 380	260	60	1.2 / 0.7	3,500	55	75	24	20
		380		60	0.6					

\* 최대사용압력은 동압 기준임.  
\* Pressure range is based on dynamic pressure.

PERFORMANCE DIAGRAM  
성능 곡선 표

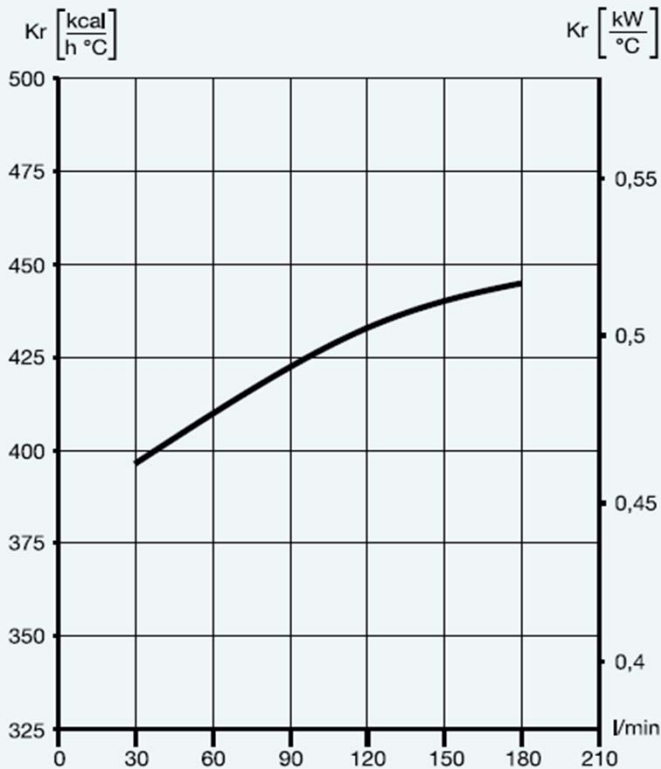

LOSS OF PRESSURE DIAGRAM  
차압 곡선 표

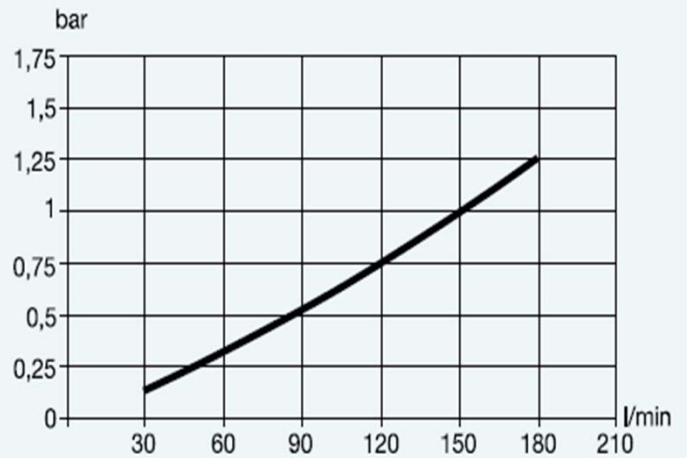

CORRECTION FACTOR  
보정 계수

cSt	22	30	46	68	100	150	220
f	0.6	1	1.5	2.3	3.5	5	7

AC MOTOR FAN COOLER – DIMENSION  
AC MOTOR FAN COOLER – 치수

AFA - - - 494

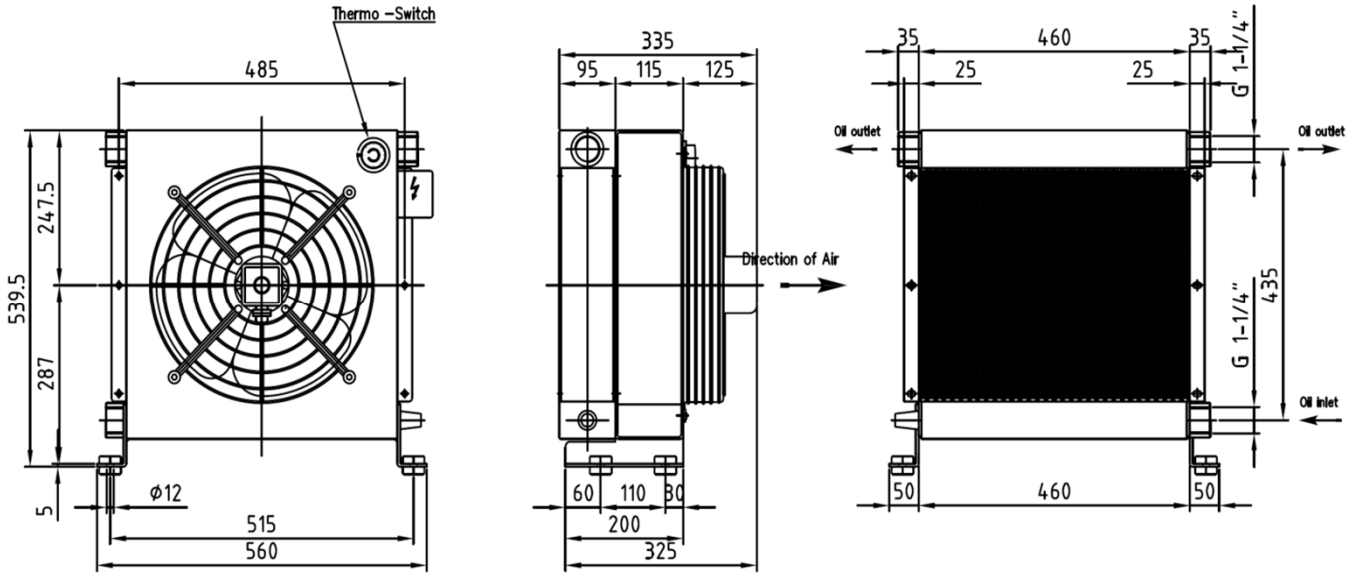

오일 유량 OIL FLOW	오일 체적 OIL CAPACITY	전압 VOLTAGE	모터 MOTOR	전류 FREQUENCY	전류 CURRENT	풍량 AIR FLOW	보호등급 PROTECTION	소음 정도 NOISE LEVEL	중량 WEIGHT	최대사용압력 PRESSURE RANGE
l/min	l	V	W	Hz	A	m <sup>3</sup> /hr	IP	dB(A)	Kg	bar
30 ~ 240	8	220 / 380	200	60	1.0 / 0.7	3,300	55	75	28	20
		380		60	0.5					

\* 최대사용압력은 동압 기준임.  
\* Pressure range is based on dynamic pressure.

PERFORMANCE DIAGRAM  
성능 곡선 표

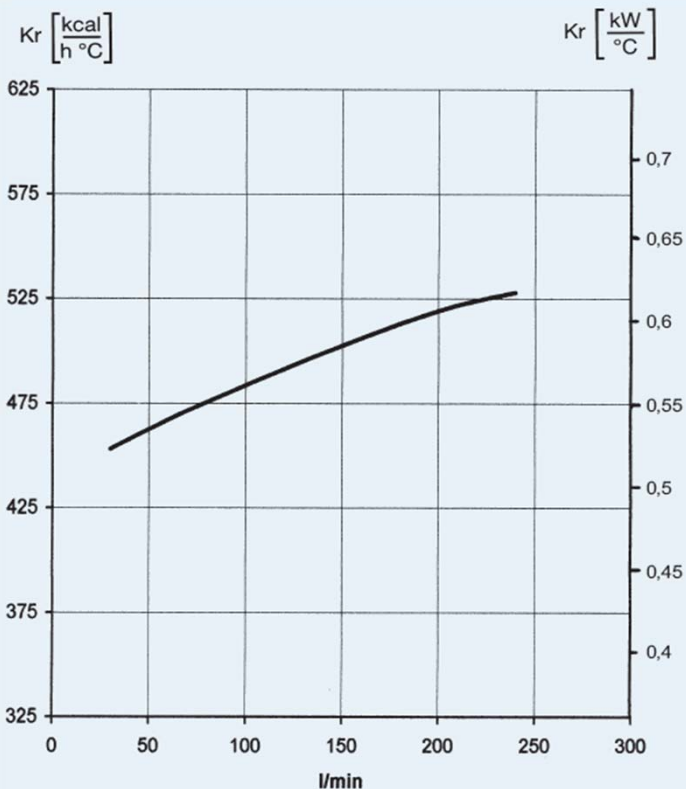

LOSS OF PRESSURE DIAGRAM  
차압 곡선 표

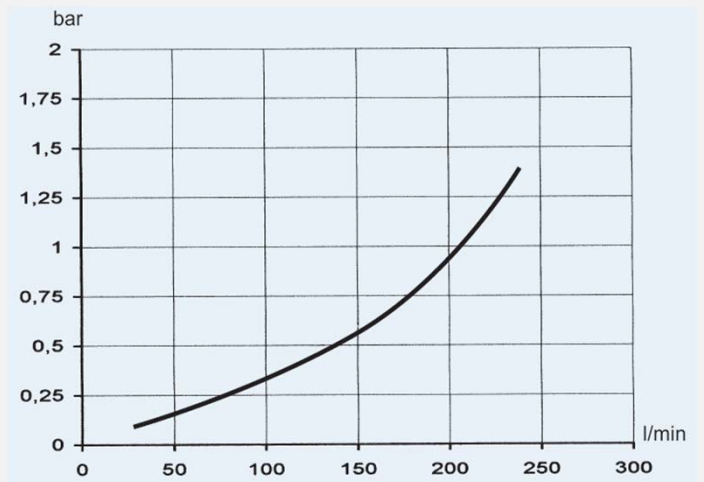

CORRECTION FACTOR  
보정 계수

cSt	22	30	46	68	100	150	220
f	0.6	1	1.5	2.3	3.5	5	7



AC MOTOR FAN COOLER – DIMENSION  
AC MOTOR FAN COOLER – 치수

AFA - - - 580

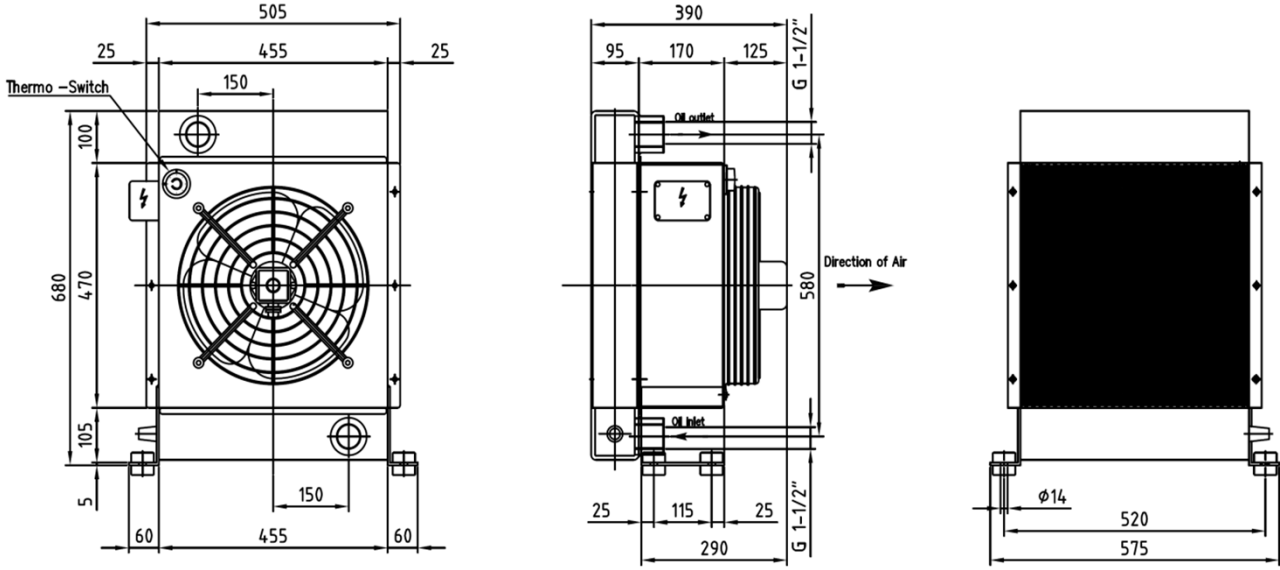

오일 유량 OIL FLOW	오일 체적 OIL CAPACITY	전압 VOLTAGE	모터 MOTOR	전류 FREQUENCY	전류 CURRENT	풍량 AIR FLOW	보호 등급 PROTECTION	소음 정도 NOISE LEVEL	중량 WEIGHT	최대사용압력* PRESSURE RANGE*
l/min	l	V	W	Hz	A	m <sup>3</sup> /hr	IP	dB(A)	Kg	bar
100 ~ 250	11.5	220 / 380	260	60	1.2 / 0.7	4,800	55	75	40	20
		380		60	0.6					

\* 최대사용압력은 동압 기준임.  
\* Pressure range is based on dynamic pressure.

PERFORMANCE DIAGRAM  
성능 곡선 표

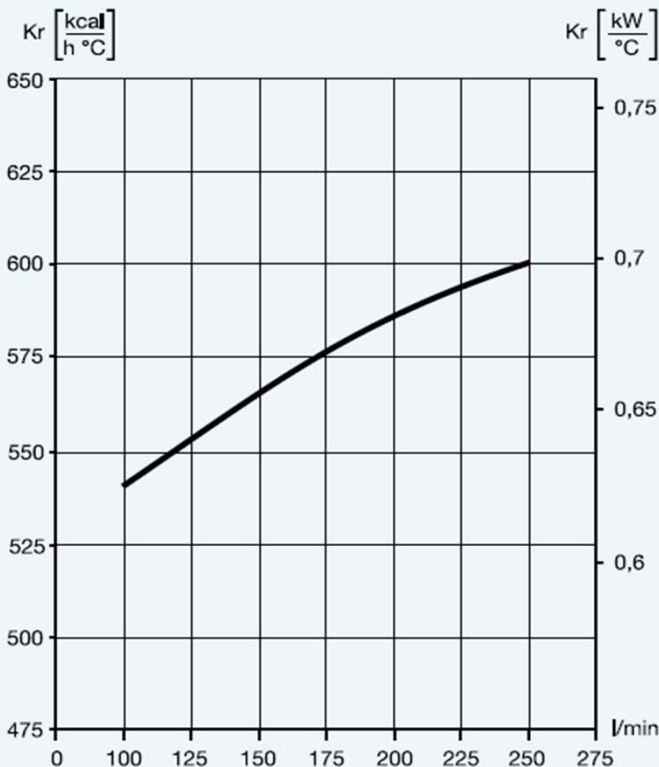

LOSS OF PRESSURE DIAGRAM  
차압 곡선 표

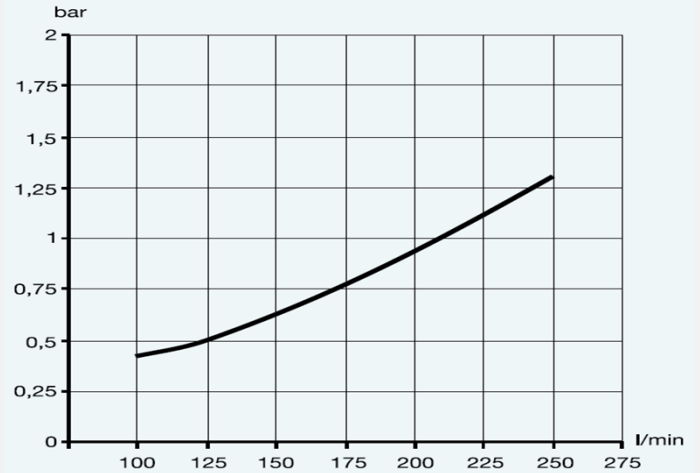

CORRECTION FACTOR  
보정 계수

cSt	22	30	46	68	100	150	220
f	0.6	1	1.5	2.3	3.5	5	7

AC MOTOR FAN COOLER – DIMENSION  
AC MOTOR FAN COOLER – 치수

AFA - - - 680

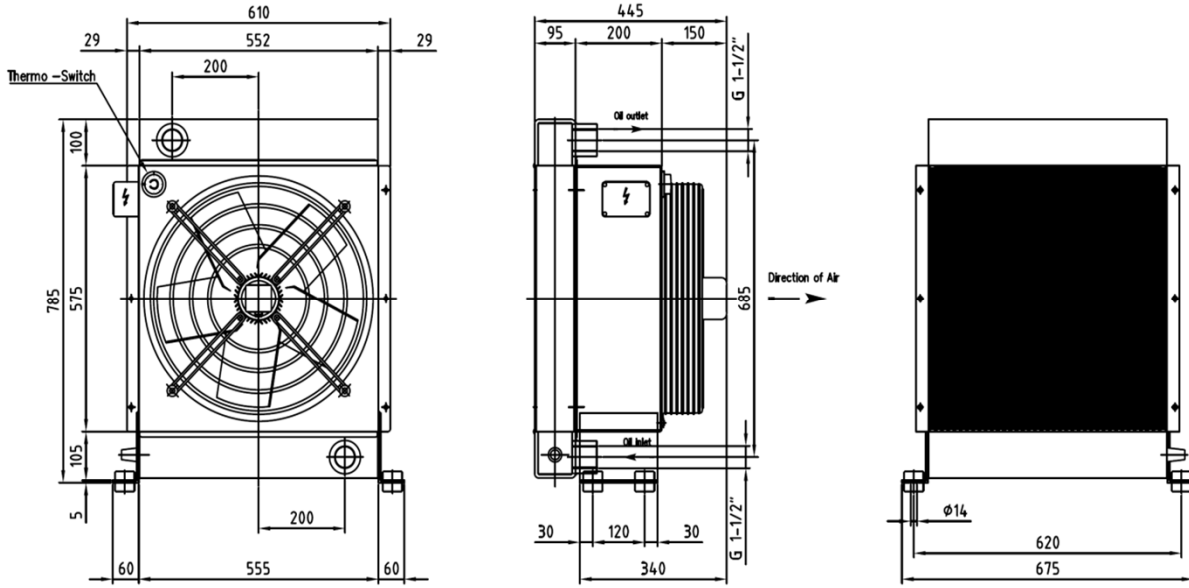

오일 유량 OIL FLOW	오일 체적 OIL CAPACITY	전압 VOLTAGE	모터 MOTOR	전류 FREQUENCY	전류 CURRENT	풍량 AIR FLOW	보호등급 PROTECTION	소음 정도 NOISE LEVEL	중량 WEIGHT	최대사용압력* PRESSURE RANGE*
l/min	l	V	W	Hz	A	m <sup>3</sup> /hr	IP	dB(A)	Kg	bar
100 ~ 300	15	220 / 380	440	60	2.0 / 1.1	8,800	55	75	62	20
		380		60	1.0					

\* 최대사용압력은 동압 기준임.  
\* Pressure range is based on dynamic pressure.

PERFORMANCE DIAGRAM  
성능 곡선 표

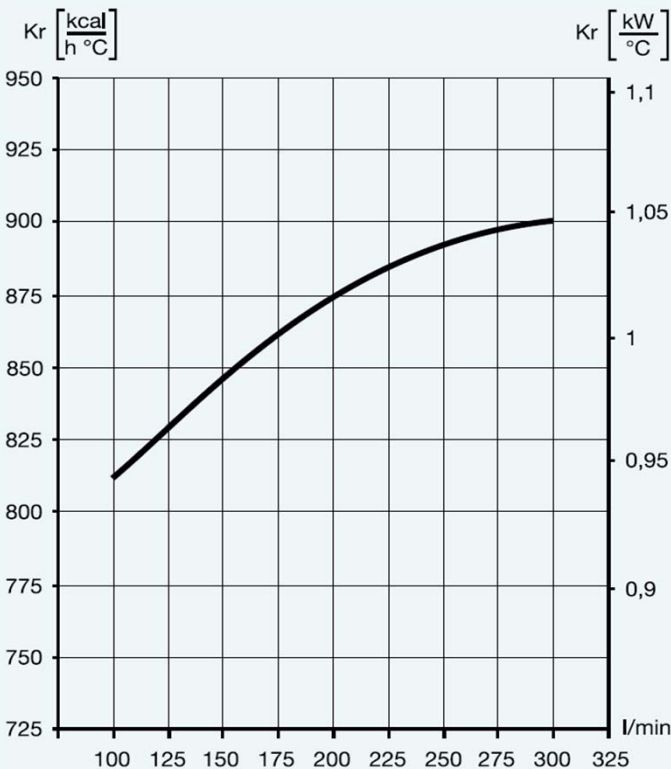

LOSS OF PRESSURE DIAGRAM  
차압 곡선 표

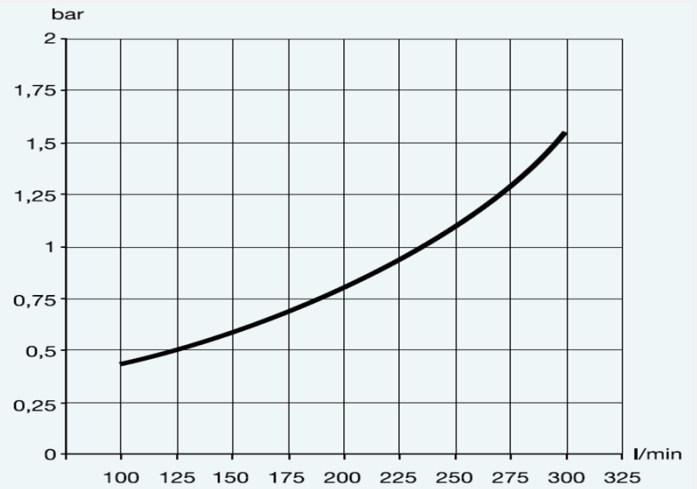

CORRECTION FACTOR  
보정 계수

cSt	22	30	46	68	100	150	220
f	0.6	1	1.5	2.3	3.5	5	7

AC MOTOR FAN COOLER – DIMENSION  
AC MOTOR FAN COOLER – 치수

AFA - - - 730

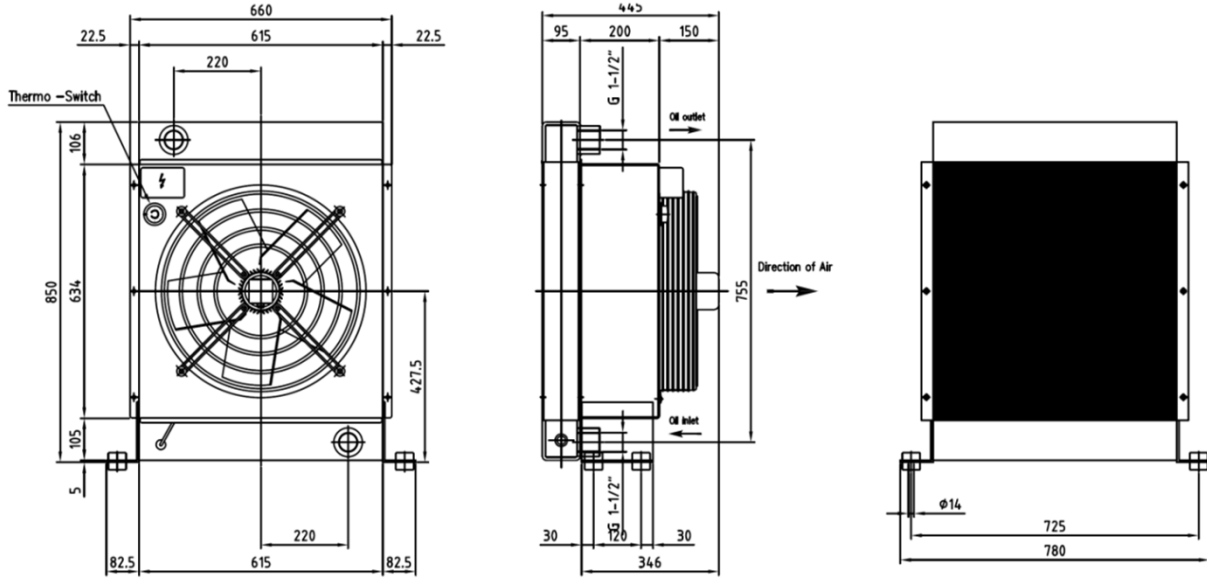

오일 유량 OIL FLOW	오일 체적 OIL CAPACITY	전압 VOLTAGE	모터 MOTOR	전류 FREQUENCY	전류 CURRENT	풍량 AIR FLOW	보호 등급 PROTECTION	소음 정도 NOISE LEVEL	중량 WEIGHT	최대사용압력* PRESSURE RANGE*
l/min	l	V	W	Hz	A	m <sup>3</sup> /hr	IP	dB(A)	Kg	bar
100 ~ 350	16	220 / 380	480	60	2.2 / 1.2	9,000	55	75	70	20
		380		60	1.1					

\* 최대사용압력은 동압 기준임.  
\* Pressure range is based on dynamic pressure.

PERFORMANCE DIAGRAM  
성능 곡선 표

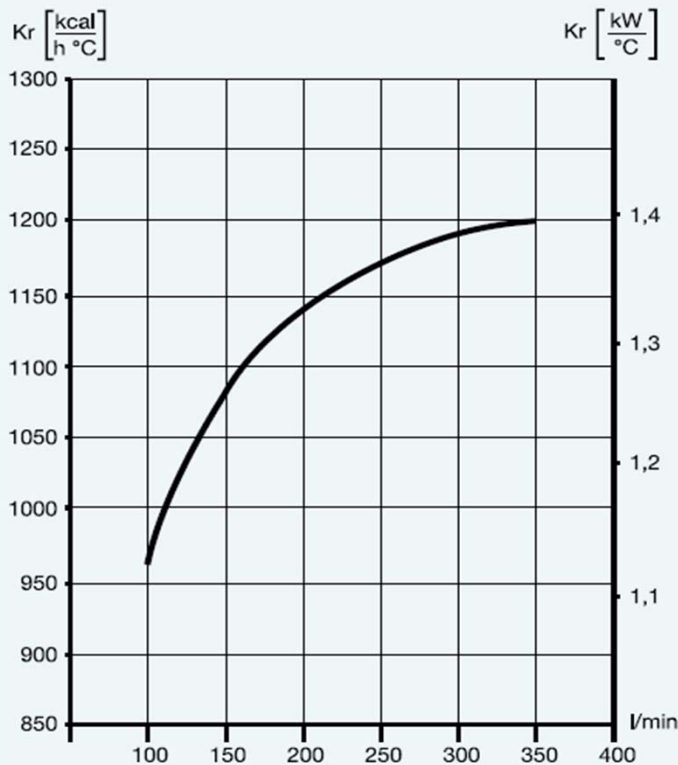

LOSS OF PRESSURE DIAGRAM  
차압 곡선 표

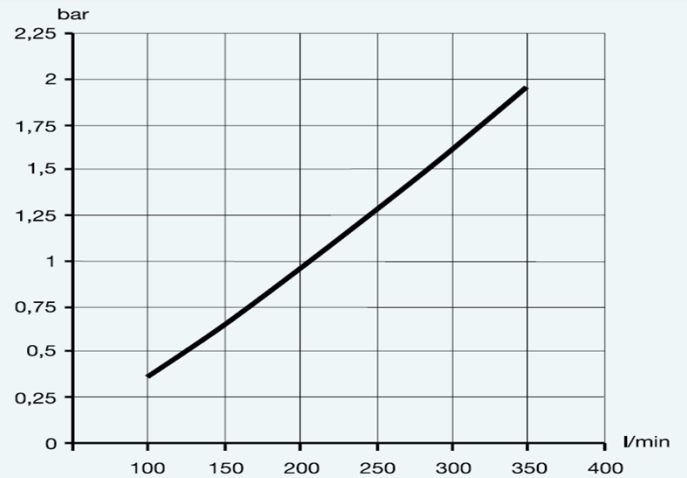

CORRECTION FACTOR  
보정 계수

cSt	22	30	46	68	100	150	220
f	0.6	1	1.5	2.3	3.5	5	7

AC MOTOR FAN COOLER – DIMENSION  
AC MOTOR FAN COOLER – 치수

AFA - - - 830

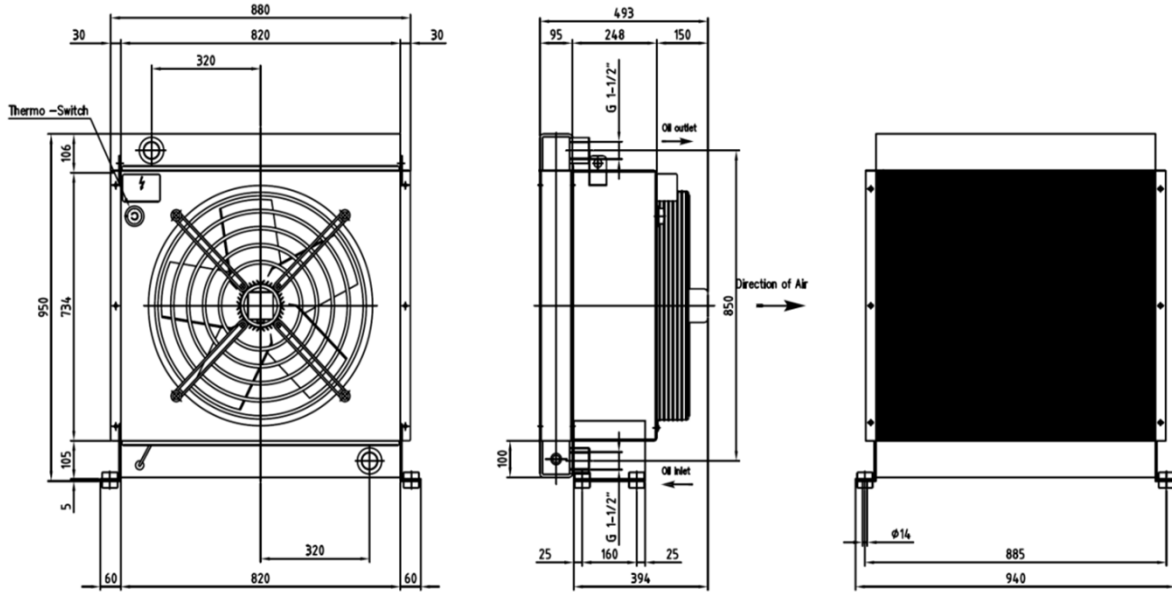

오일 유량 OIL FLOW	오일 체적 OIL CAPACITY	전압 VOLTAGE	모터 MOTOR	전류 FREQUENCY	전류 CURRENT	풍량 AIR FLOW	보호등급 PROTECTION	소음 정도 NOISE LEVEL	중량 WEIGHT	최대사용압력 PRESSURE RANGE
l/min	l	V	W	Hz	A	m <sup>3</sup> /hr	IP	dB(A)	Kg	bar
150 ~ 400	20	220 / 380	750	60	3.4 / 1.9	11,000	55	75	83	20
		380		60						

\* 최대사용압력은 동압 기준임.  
\* Pressure range is based on dynamic pressure.

PERFORMANCE DIAGRAM  
성능 곡선 표

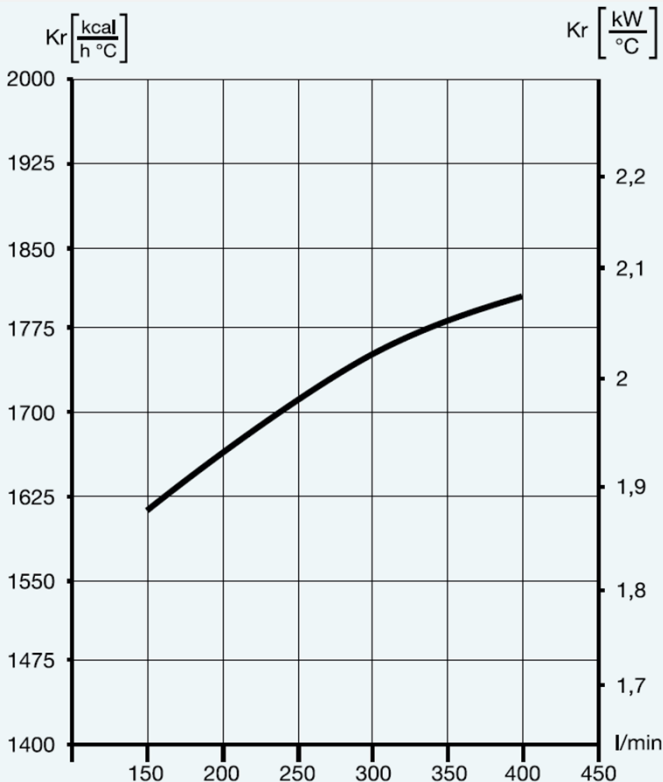

LOSS OF PRESSURE DIAGRAM  
차압 곡선 표

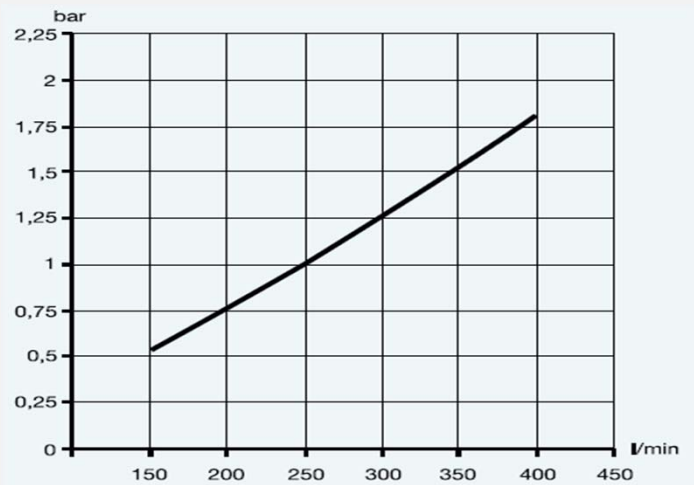

CORRECTION FACTOR  
보정 계수

cSt	22	30	46	68	100	150	220
f	0.6	1	1.5	2.3	3.5	5	7

DC MOTOR FAN COOLER – DIMENSION  
DC MOTOR FAN COOLER – 치수

AFD - - - 240

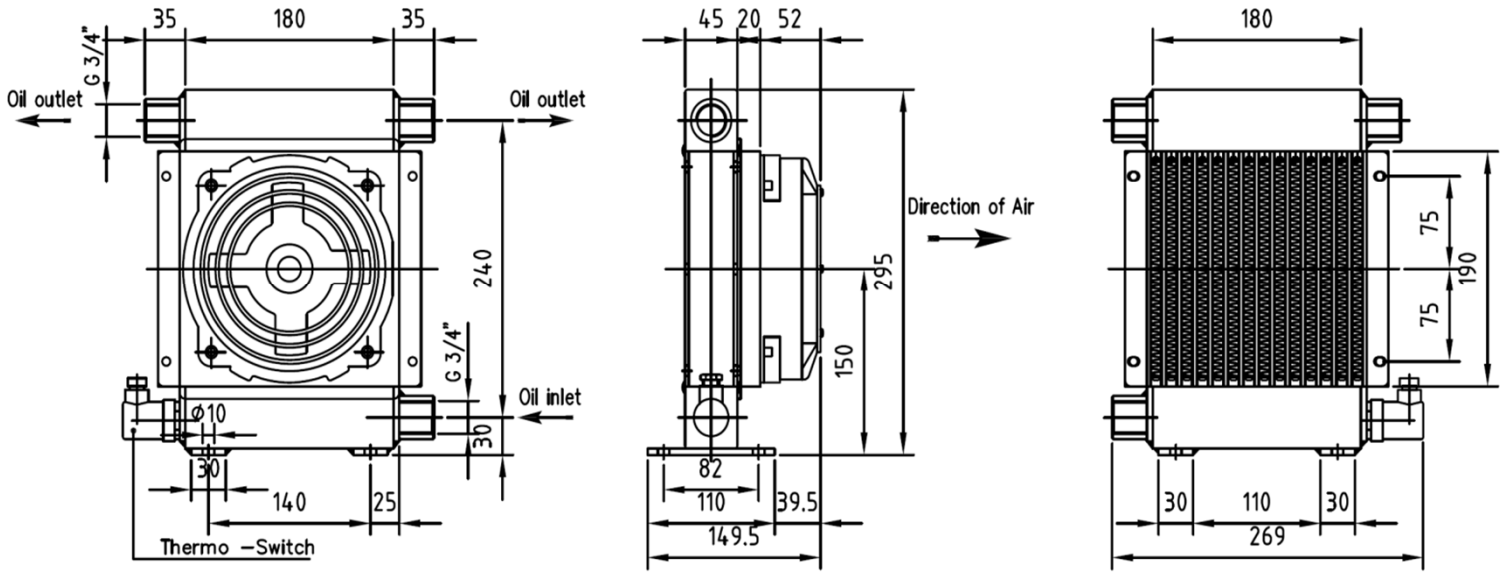

오일 유량 OIL FLOW	오일 체적 OIL CAPACITY	전압 VOLTAGE	모터 MOTOR	전류 CURRENT	풍량 AIR FLOW	보호 등급 PROTECTION	소음 정도 NOISE LEVEL	중량 WEIGHT	최대사용압력* PRESSURE RANGE*
l/min	l	DC V	W	A	m <sup>3</sup> /hr	IP	dB(A)	Kg	bar
10 ~ 80	1	24	79.2	3.3	400	68	72	5	20

\* 최대사용압력은 동압 기준임.  
\* Pressure range is based on dynamic pressure.

PERFORMANCE DIAGRAM  
성능 곡선 표

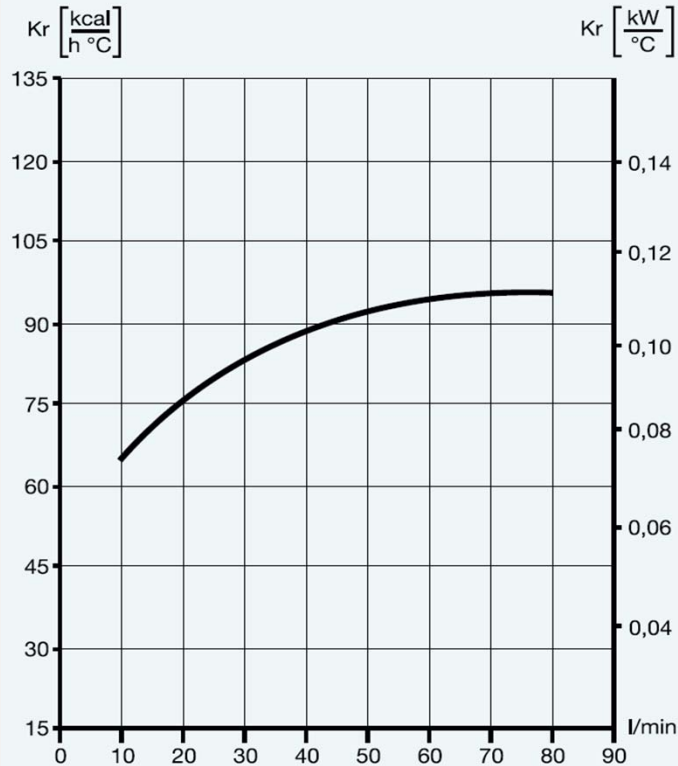

LOSS OF PRESSURE DIAGRAM  
차압 곡선 표

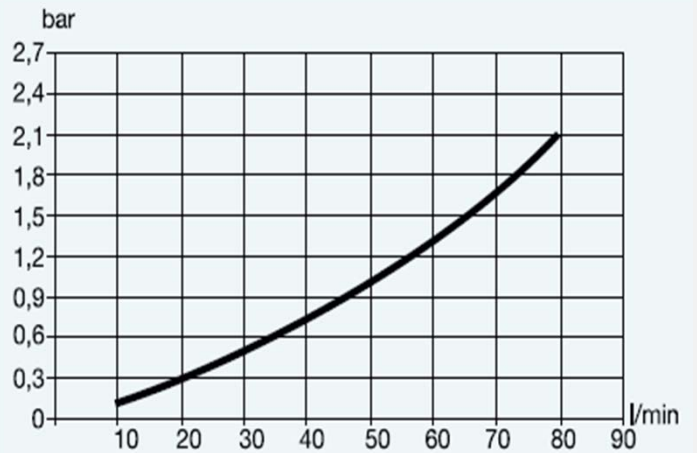

CORRECTION FACTOR  
보정 계수

cSt	22	30	46	68	100	150	220
f	0.6	1	1.5	2.3	3.5	5	7

DC MOTOR FAN COOLER – DIMENSION  
 DC MOTOR FAN COOLER – 치수

AFD - - - 263

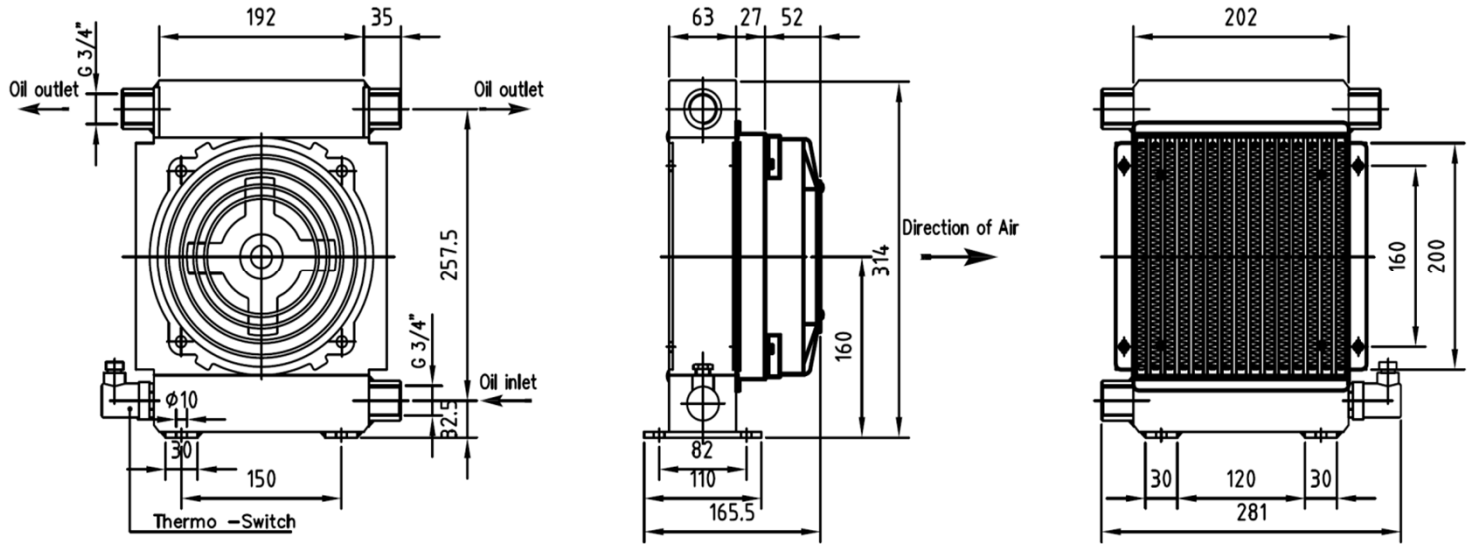

오일 유량 OIL FLOW	오일 체적 OIL CAPACITY	전압 VOLTAGE	모터 MOTOR	전류 CURRENT	풍량 AIR FLOW	보호 등급 PROTECTION	소음 정도 NOISE LEVEL	중량 WEIGHT	최대사용압력* PRESSURE RANGE*
l/min	l	DC V	W	A	m <sup>3</sup> /hr	IP	dB(A)	Kg	bar
10 ~ 90	1.7	24	62.4	2.6	520	68	75	6	20

\* 최대사용압력은 동압 기준임.  
 \* Pressure range is based on dynamic pressure.

PERFORMANCE DIAGRAM  
 성능 곡선 표



LOSS OF PRESSURE DIAGRAM  
 차압 곡선 표

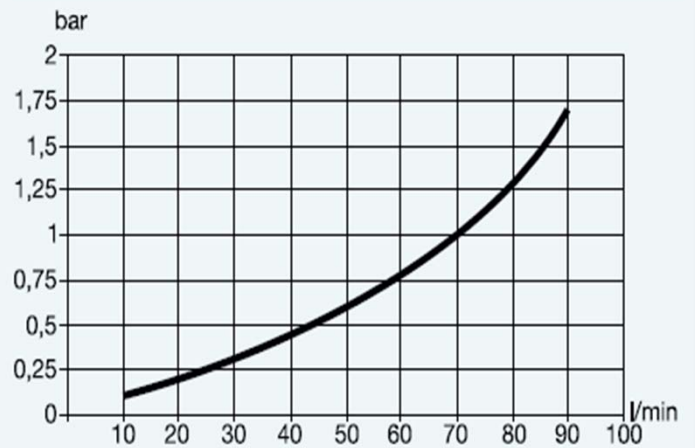

CORRECTION FACTOR  
 보정 계수

cSt	22	30	46	68	100	150	220
f	0.6	1	1.5	2.3	3.5	5	7

DC MOTOR FAN COOLER – DIMENSION  
DC MOTOR FAN COOLER – 치수

AFD - - - 300

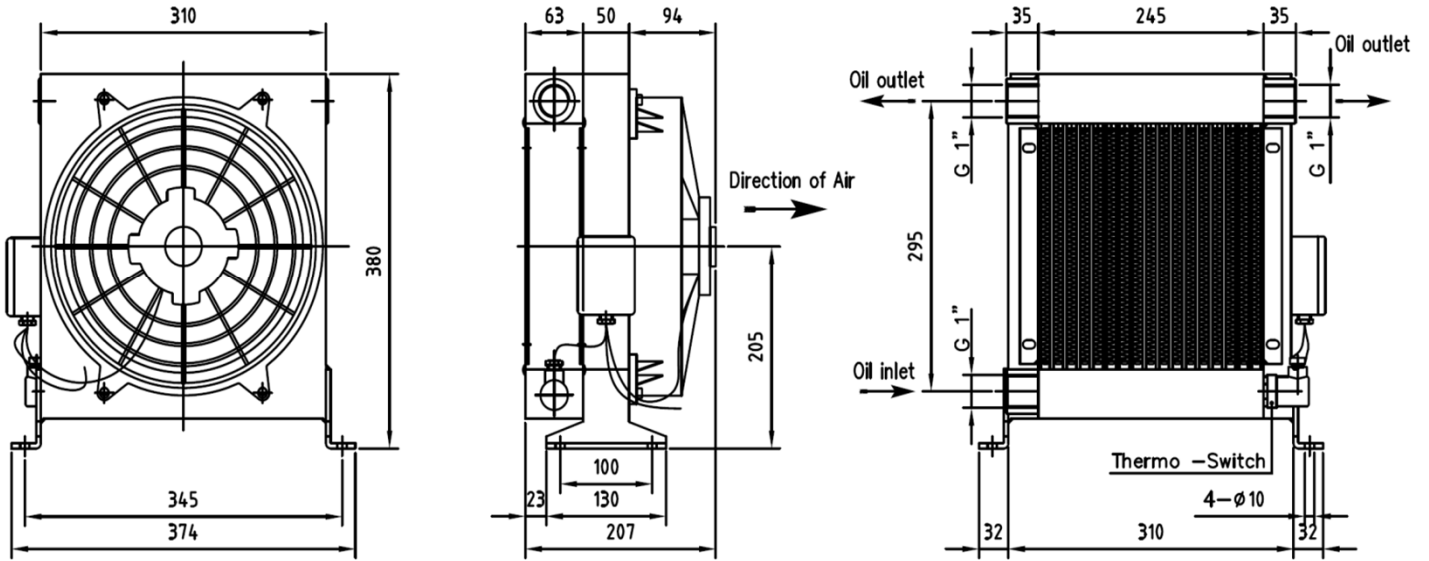

오일 유량 OIL FLOW	오일 체적 OIL CAPACITY	전압 VOLTAGE	모터 MOTOR	전류 CURRENT	풍량 AIR FLOW	보호 등급 PROTECTION	소음 정도 NOISE LEVEL	중량 WEIGHT	최대사용압력* PRESSURE RANGE*
l/min	l	DC V	W	A	m <sup>3</sup> /hr	IP	dB(A)	Kg	bar
20 ~ 150	2	24	213.6	8.9	1,650	68	68	10	20

\* 최대사용압력은 동압 기준임.  
\* Pressure range is based on dynamic pressure.

PERFORMANCE DIAGRAM  
성능 곡선 표

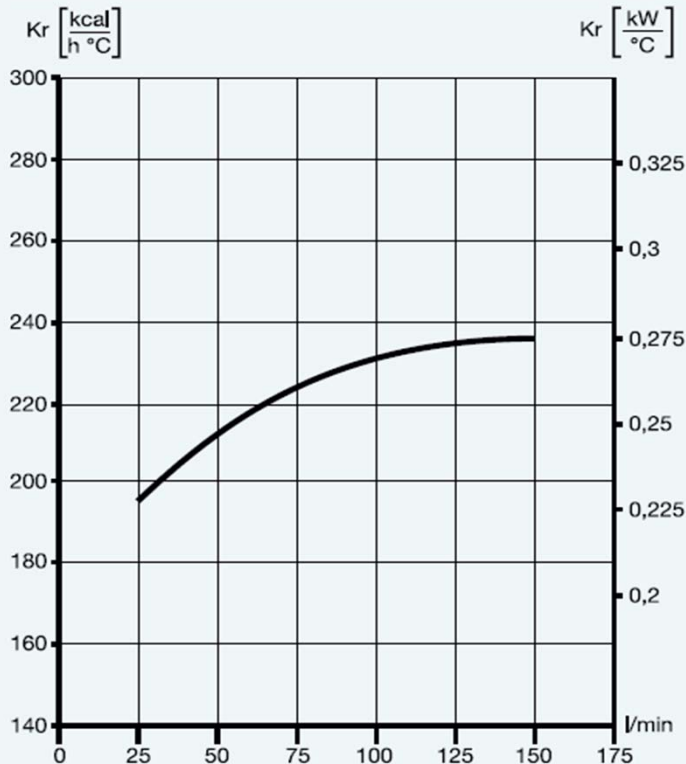

LOSS OF PRESSURE DIAGRAM  
차압 곡선 표

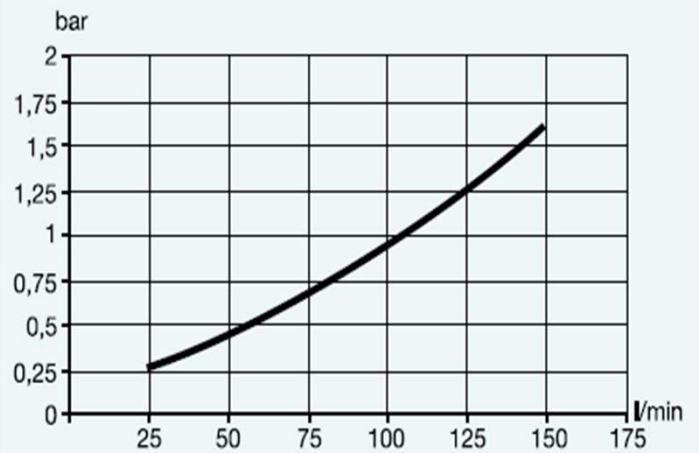

CORRECTION FACTOR  
보정 계수

cSt	22	30	46	68	100	150	220
f	0.6	1	1.5	2.3	3.5	5	7

DC MOTOR FAN COOLER – DIMENSION  
DC MOTOR FAN COOLER – 치수

AFD - - - 300/2

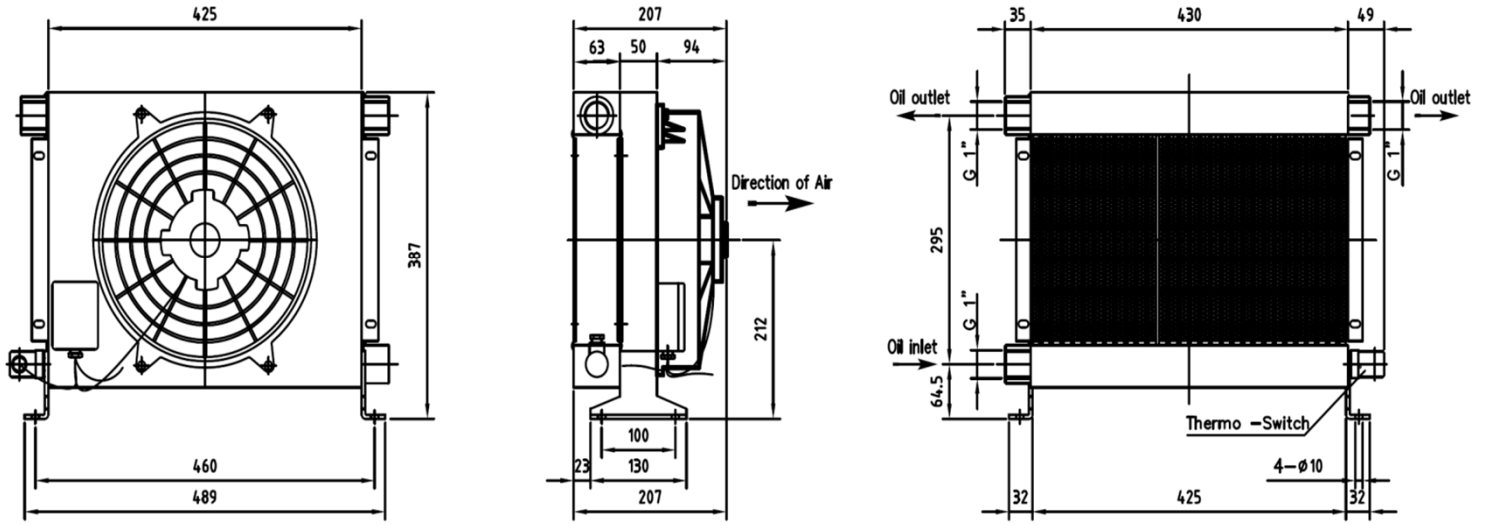

오일 유량 OIL FLOW	오일 체적 OIL CAPACITY	전압 VOLTAGE	모터 MOTOR	전류 CURRENT	풍량 AIR FLOW	보호 등급 PROTECTION	소음 정도 NOISE LEVEL	중량 WEIGHT	최대사용압력* PRESSURE RANGE*
l/min	l	DC V	W	A	m <sup>3</sup> /hr	IP	dB(A)	Kg	bar
30 ~ 180	3.6	24	220.8	9.2	1,810	68	83	14	20

\* 최대사용압력은 동압 기준임.  
\* Pressure range is based on dynamic pressure.

PERFORMANCE DIAGRAM  
성능 곡선 표



LOSS OF PRESSURE DIAGRAM  
차압 곡선 표

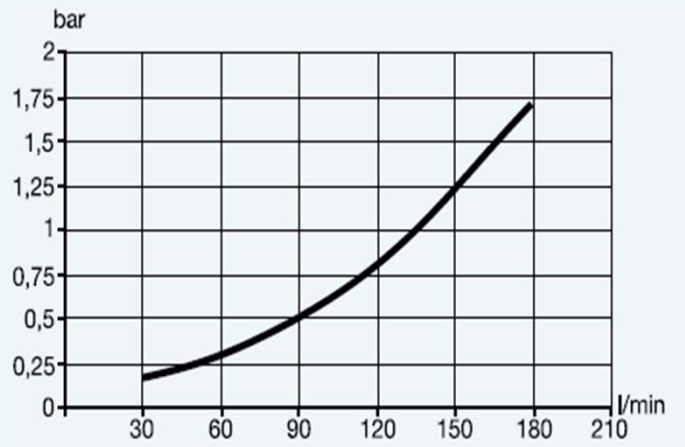

CORRECTION FACTOR  
보정 계수

cSt	22	30	46	68	100	150	220
f	0.6	1	1.5	2.3	3.5	5	7



DC MOTOR FAN COOLER – DIMENSION  
 DC MOTOR FAN COOLER – 치수

AFD - - - 430

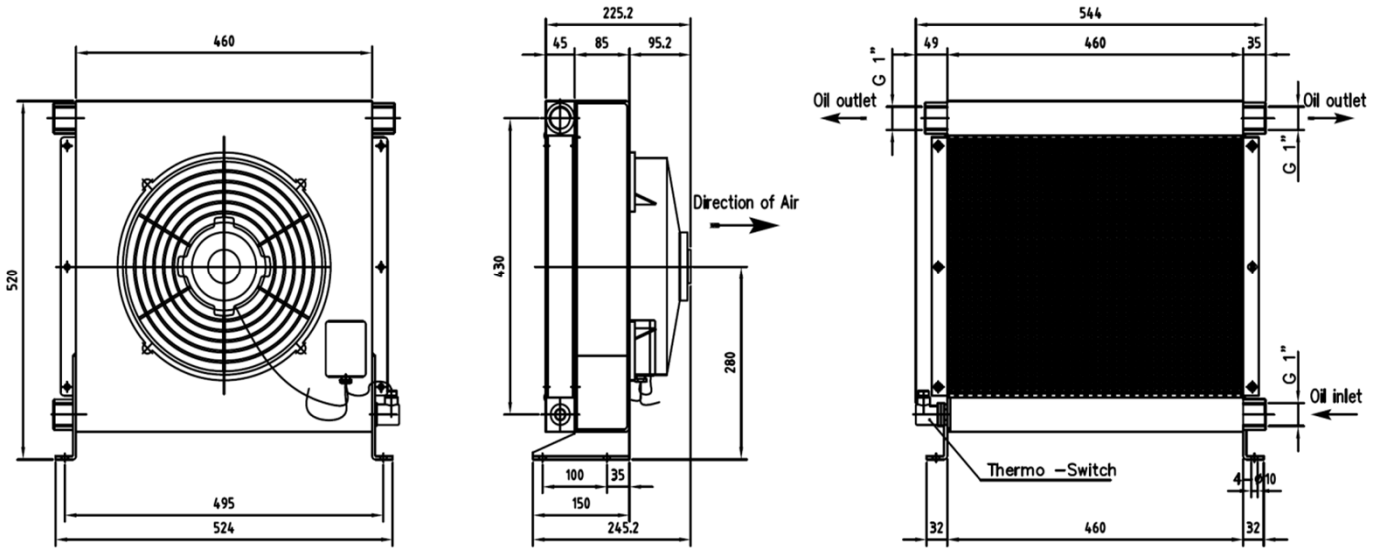

오일 유량 OIL FLOW	오일 체적 OIL CAPACITY	전압 VOLTAGE	모터 MOTOR	전류 CURRENT	풍량 AIR FLOW	보호 등급 PROTECTION	소음 정도 NOISE LEVEL	중량 WEIGHT	최대사용압력 PRESSURE RANGE
l/min	l	DC V	W	A	m <sup>3</sup> /hr	IP	dB(A)	Kg	bar
20 ~ 150	3.6	24	240	10	2,060	68	82	16	20

\* 최대사용압력은 동압 기준임.  
 \* Pressure range is based on dynamic pressure.

PERFORMANCE DIAGRAM  
 성능 곡선 표



LOSS OF PRESSURE DIAGRAM  
 차압 곡선 표

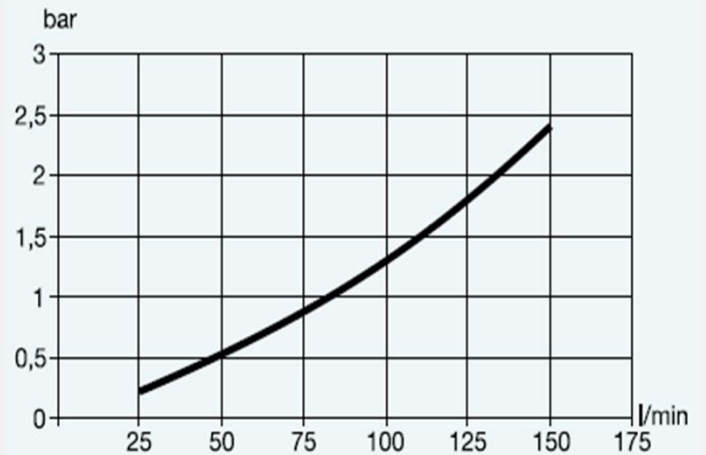

CORRECTION FACTOR  
 보정 계수

cSt	22	30	46	68	100	150	220
f	0.6	1	1.5	2.3	3.5	5	7

DC MOTOR FAN COOLER – DIMENSION  
DC MOTOR FAN COOLER – 치수

AFD - - - 430/2

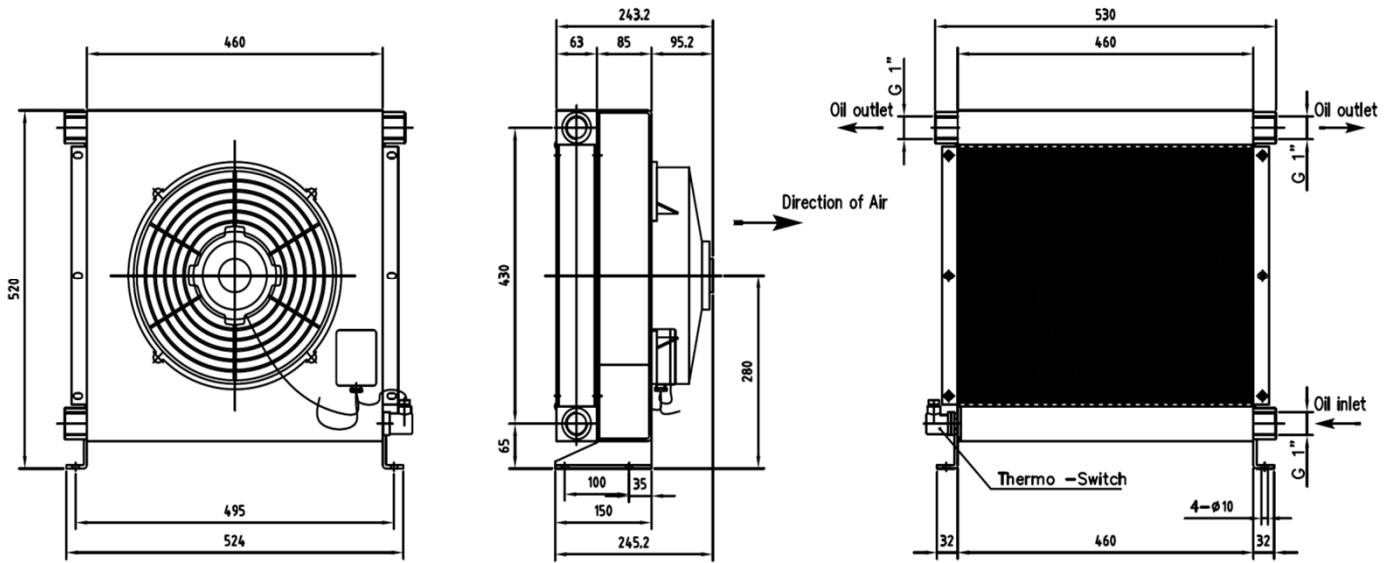

오일 유량 OIL FLOW	오일 체적 OIL CAPACITY	전압 VOLTAGE	모터 MOTOR	전류 CURRENT	풍량 AIR FLOW	보호 등급 PROTECTION	소음 정도 NOISE LEVEL	중량 WEIGHT	최대사용압력* PRESSURE RANGE*
l/min	l	DC V	W	A	m <sup>3</sup> /hr	IP	dB(A)	Kg	bar
30 ~ 200	5.5	24	252	10.5	2,210	68	82	20	20

\* 최대사용압력은 동압 기준임.  
\* Pressure range is based on dynamic pressure.

PERFORMANCE DIAGRAM  
성능 곡선 표



LOSS OF PRESSURE DIAGRAM  
차압 곡선 표

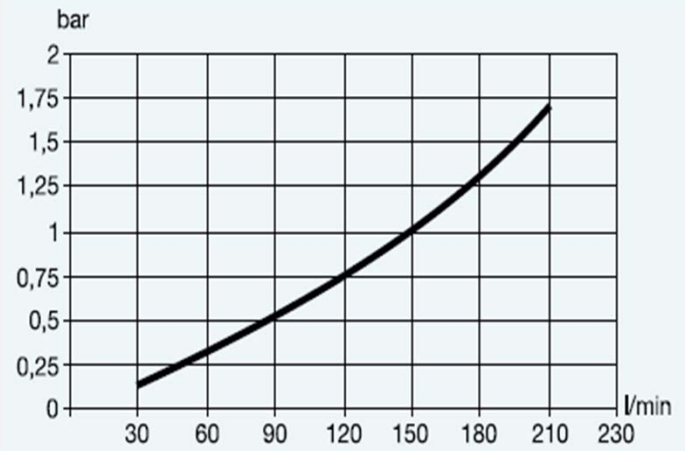

CORRECTION FACTOR  
보정 계수

cSt	22	30	46	68	100	150	220
f	0.6	1	1.5	2.3	3.5	5	7

DC MOTOR FAN COOLER – DIMENSION  
DC MOTOR FAN COOLER – 치수

AFD - - - 494

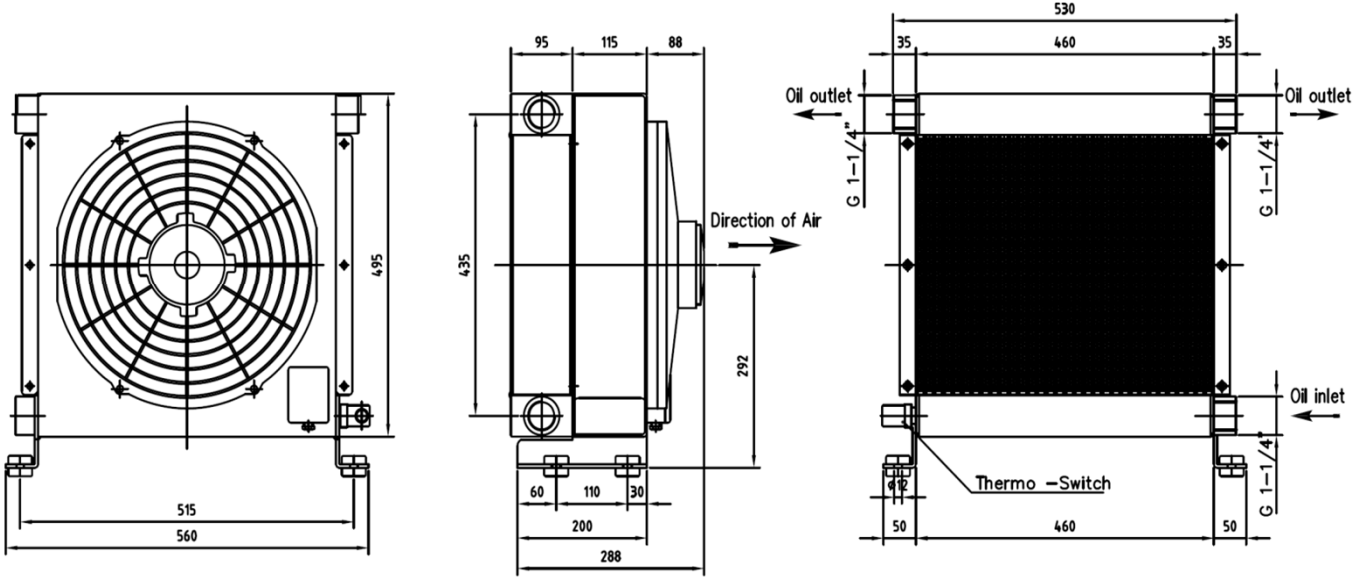

오일 유량 OIL FLOW	오일 체적 OIL CAPACITY	전압 VOLTAGE	모터 MOTOR	전류 CURRENT	풍량 AIR FLOW	보호 등급 PROTECTION	소음 정도 NOISE LEVEL	중량 WEIGHT	최대사용압력 PRESSURE RANGE
l/min	l	DC V	W	A	m <sup>3</sup> /hr	IP	dB(A)	Kg	bar
30 ~ 240	8	24	244.8	10.2	2,670	68	85	25	20

\* 최대사용압력은 동압 기준임.  
\* Pressure range is based on dynamic pressure.

PERFORMANCE DIAGRAM  
성능 곡선 표

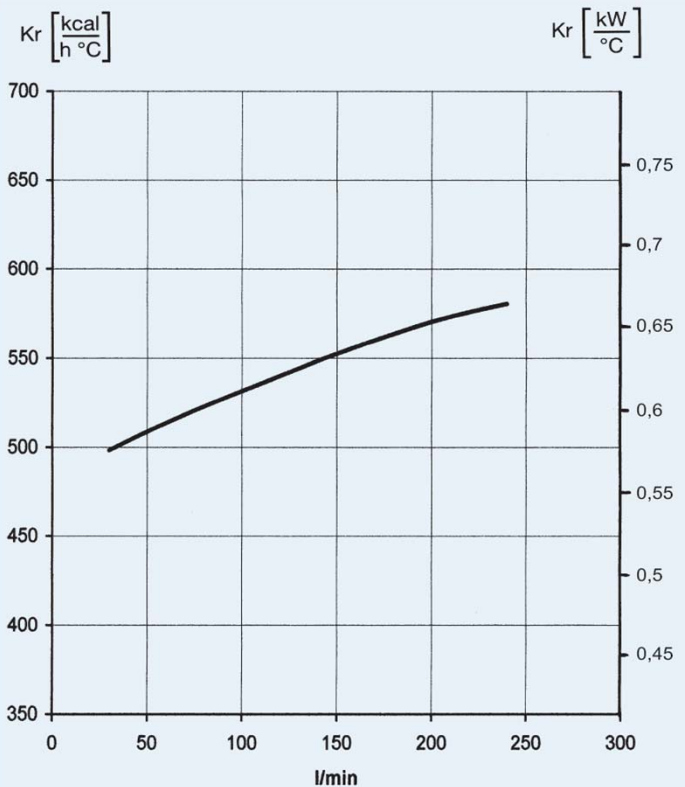

LOSS OF PRESSURE DIAGRAM  
차압 곡선 표

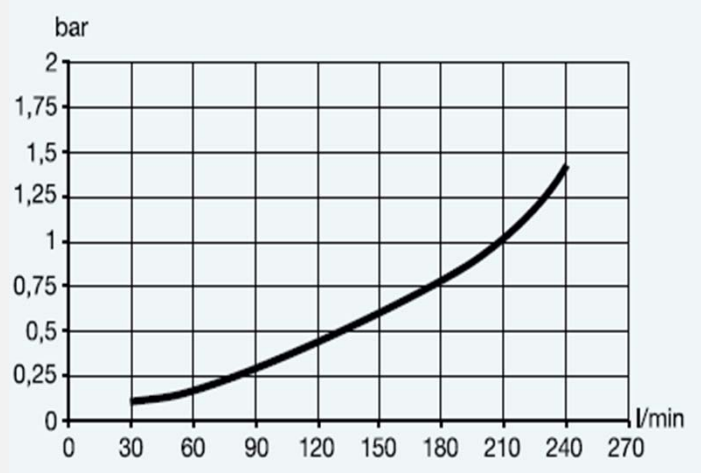

CORRECTION FACTOR  
보정 계수

cSt	22	30	46	68	100	150	220
f	0.6	1	1.5	2.3	3.5	5	7

DC MOTOR FAN COOLER – DIMENSION  
DC MOTOR FAN COOLER – 치수

AFD - - - 580

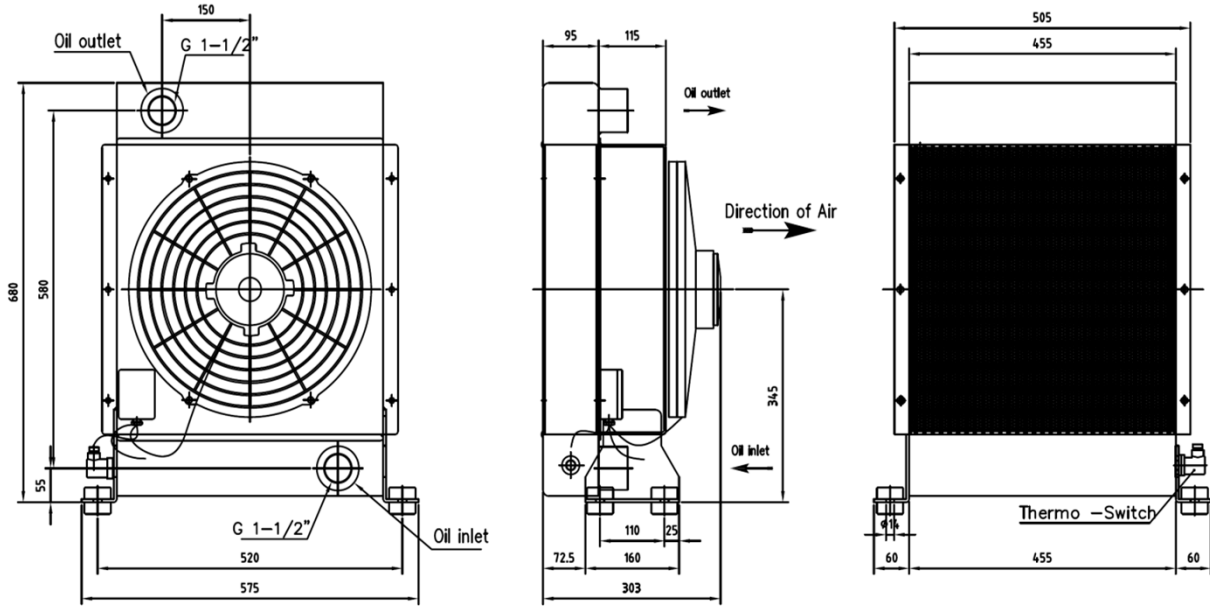

오일 유량 OIL FLOW	오일 체적 OIL CAPACITY	전압 VOLTAGE	모터 MOTOR	전류 CURRENT	풍량 AIR FLOW	보호 등급 PROTECTION	소음 정도 NOISE LEVEL	중량 WEIGHT	최대사용압력* PRESSURE RANGE*
l/min	l	DC V	W	A	m <sup>3</sup> /hr	IP	dB(A)	Kg	bar
50 ~ 250	11.5	24	249.6	10.4	2,700	68	85	33	20

\* 최대사용압력은 동압 기준임.  
\* Pressure range is based on dynamic pressure.

PERFORMANCE DIAGRAM  
성능 곡선 표

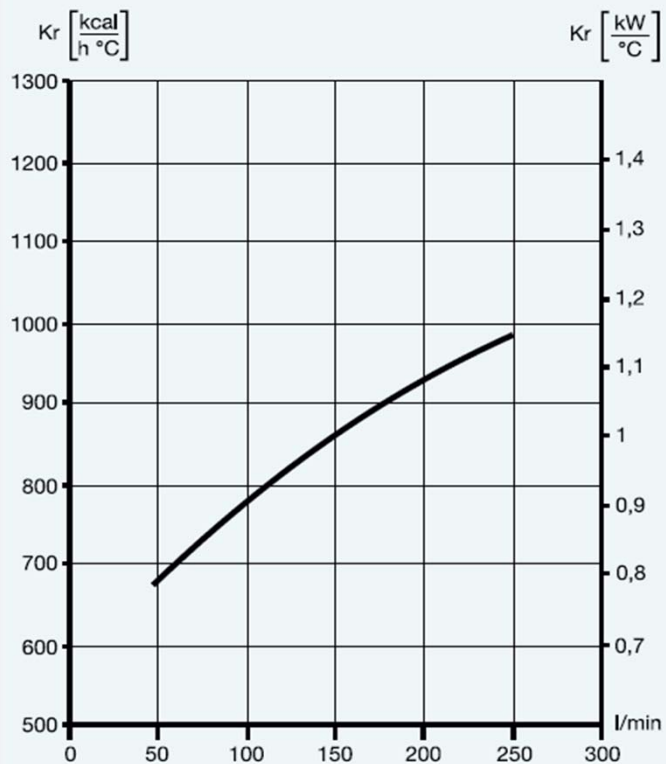

LOSS OF PRESSURE DIAGRAM  
차압 곡선 표

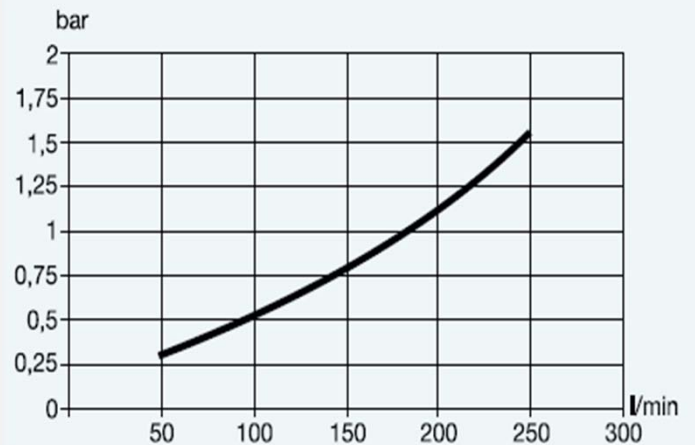

CORRECTION FACTOR  
보정 계수

cSt	22	30	46	68	100	150	220
f	0.6	1	1.5	2.3	3.5	5	7

HYDRAULIC MOTOR FAN COOLER – DIMENSION  
 HYDRAULIC MOTOR FAN COOLER – 치수

AFH - - - 300

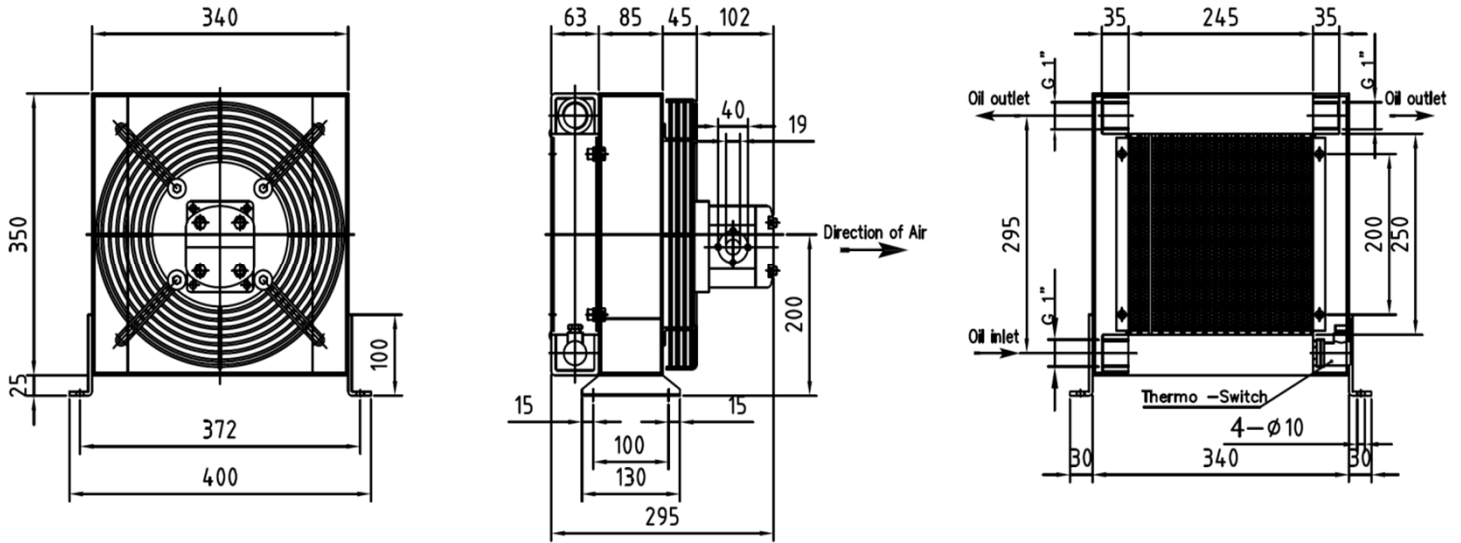

오일유량 OIL FLOW	오일체적 OIL CAPACITY	모터유량 MOTOR FLOW	토출유량 DISPLACEMENT	모터 POWER	풍량 AIR FLOW	회전수 RPM	소음정도 NOISE LEVEL	중량 WEIGHT	최대사용압력* PRESSURE RANGE*
l/min	l	LPM	cc/Rev	W	m <sup>3</sup> /hr	rpm	dB(A)	Kg	Bar
10 ~ 80	2	26	11.3	200	2,000	2,300	68	14	20

\* 최대사용압력은 동압 기준임.  
 \* Pressure range is based on dynamic pressure.

PERFORMANCE DIAGRAM  
 성능 곡선 표

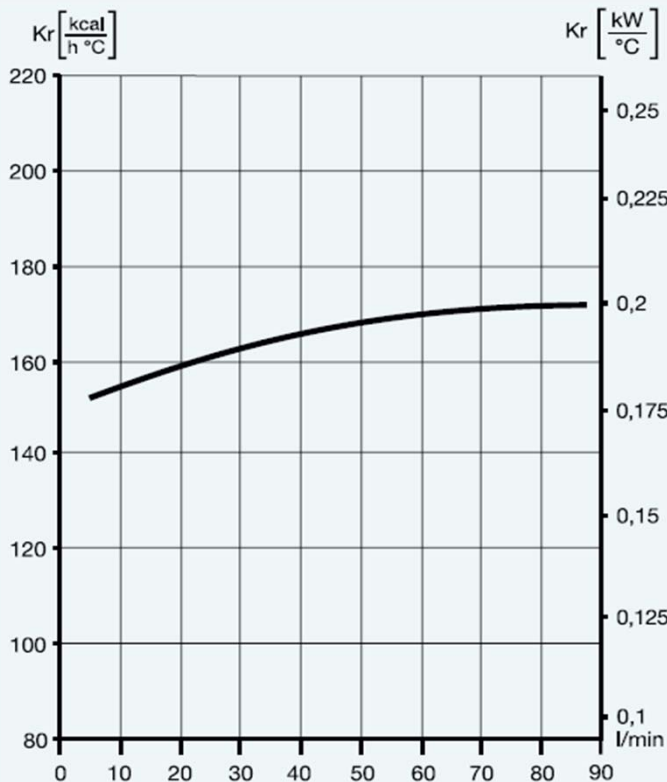

LOSS OF PRESSURE DIAGRAM  
 차압 곡선 표

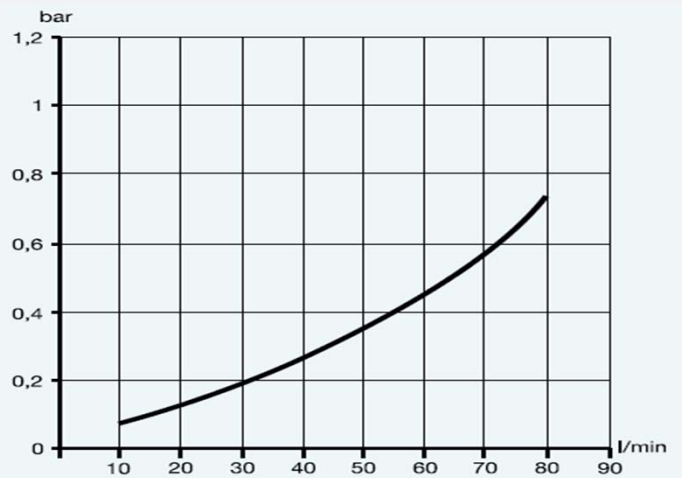

CORRECTION FACTOR  
 보정 계수

cSt	22	30	46	68	100	150	220
f	0.6	1	1.5	2.3	3.5	5	7

HYDRAULIC MOTOR FAN COOLER – DIMENSION  
 HYDRAULIC MOTOR FAN COOLER – 치수

AFH - - - 300/2

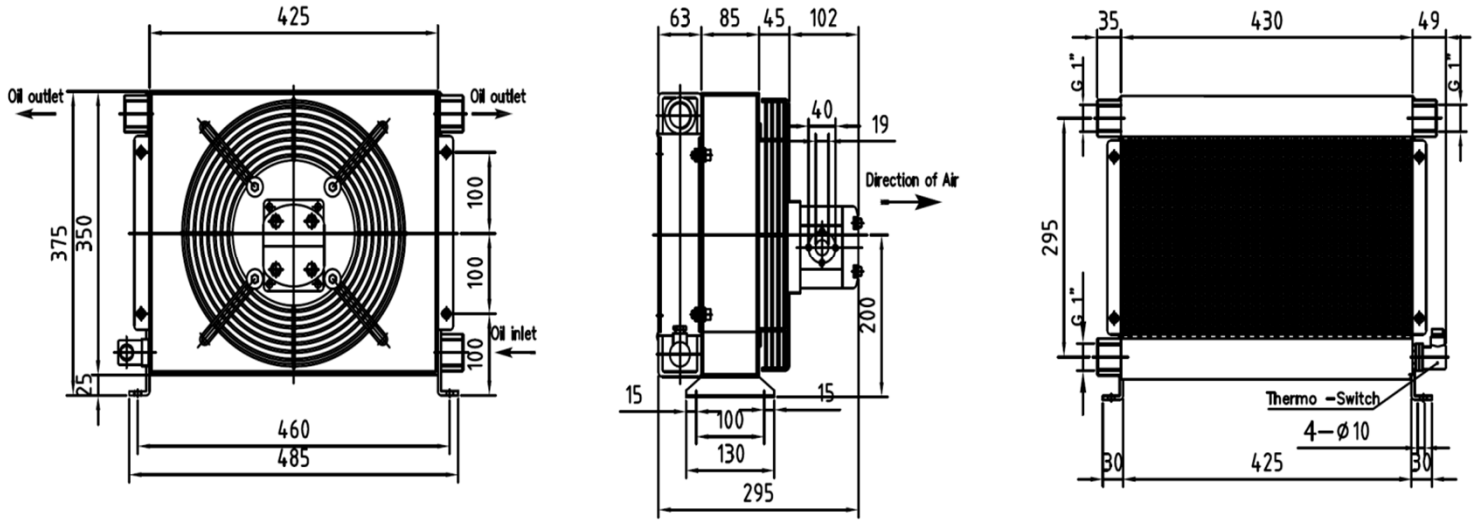

오일유량 OIL FLOW	오일체적 OIL CAPACITY	모터유량 MOTOR FLOW	토출유량 DISPLACEMENT	모터 POWER	풍량 AIR FLOW	회전수 RPM	소음 정도 NOISE LEVEL	중량 WEIGHT	최대사용압력* PRESSURE RANGE*
l/min	l	LPM	cc/Rev	W	m <sup>3</sup> /hr	rpm	dB(A)	Kg	Bar
20 ~ 150	19	26	11.3	200	2,500	2,300	70	19	20

\* 최대사용압력은 동압 기준임.  
 \* Pressure range is based on dynamic pressure.

PERFORMANCE DIAGRAM  
 성능 곡선 표

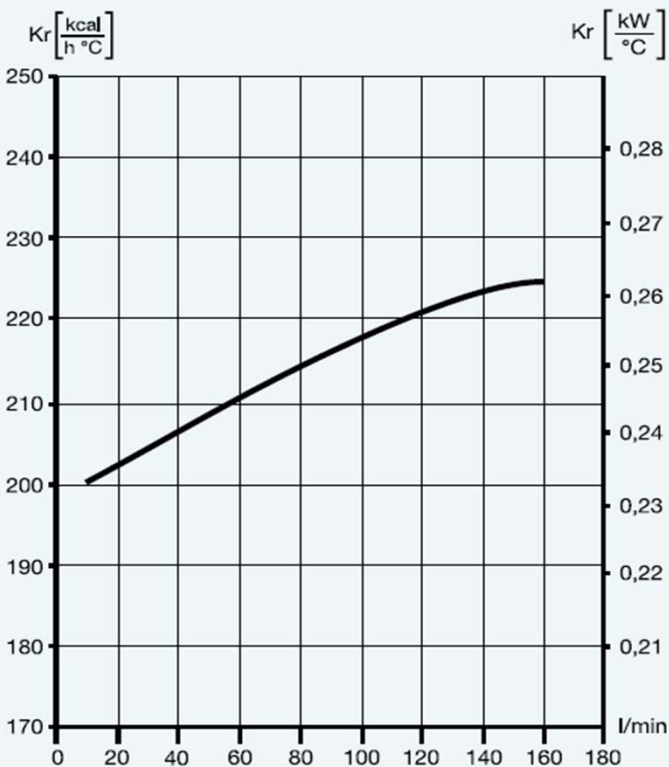

LOSS OF PRESSURE DIAGRAM  
 차압 곡선 표

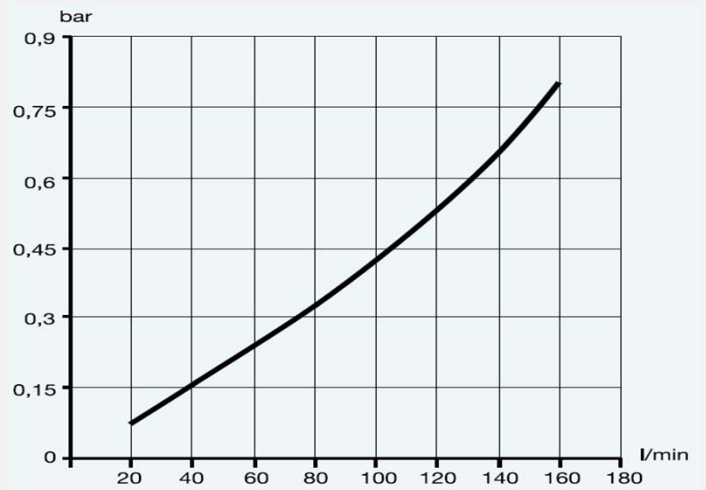

CORRECTION FACTOR  
 보정 계 수

cSt	22	30	46	68	100	150	220
f	0.6	1	1.5	2.3	3.5	5	7

HYDRAULIC MOTOR FAN COOLER – DIMENSION  
 HYDRAULIC MOTOR FAN COOLER – 치수

AFH - - - 430

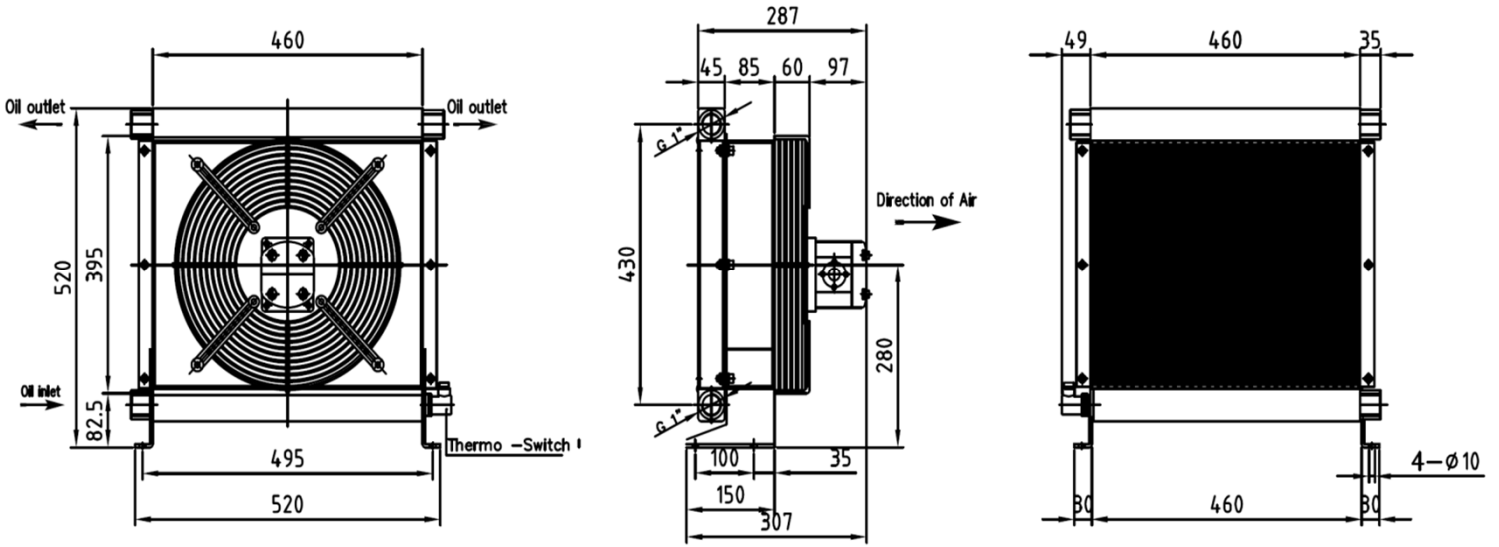

오일유량 OIL FLOW	오일체적 OIL CAPACITY	모터유량 MOTOR FLOW	토출유량 DISPLACEMENT	모터 POWER	풍량 AIR FLOW	회전수 RPM	소음정도 NOISE LEVEL	중량 WEIGHT	최대사용압력* PRESSURE RANGE*
l/min	l	LPM	cc/Rev	W	m <sup>3</sup> /hr	rpm	dB(A)	Kg	Bar
30 ~ 150	3.6	31	11.3	770	7,000	2,700	71	21	20

\* 최대사용압력은 동압 기준임.  
 \* Pressure range is based on dynamic pressure.

PERFORMANCE DIAGRAM  
 성능 곡선 표

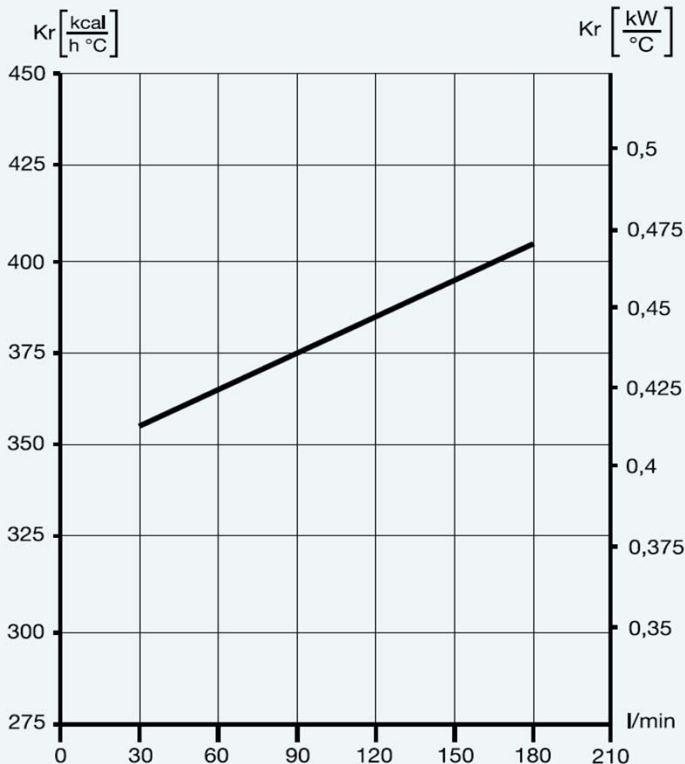

LOSS OF PRESSURE DIAGRAM  
 차압 곡선 표

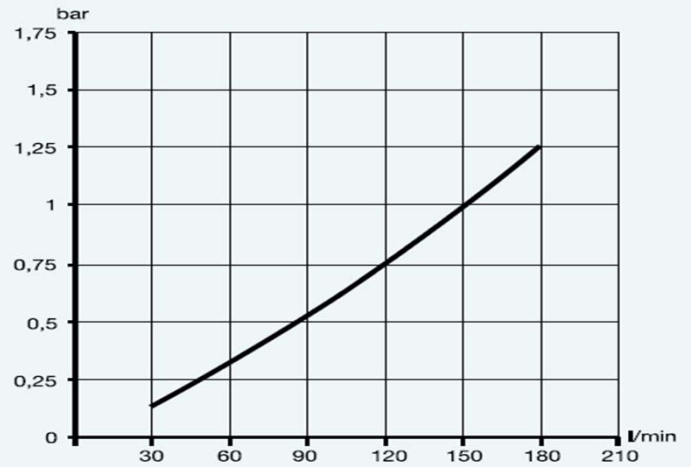

CORRECTION FACTOR  
 보정 계수

cSt	22	30	46	68	100	150	220
f	0.6	1	1.5	2.3	3.5	5	7

HYDRAULIC MOTOR FAN COOLER – DIMENSION  
 HYDRAULIC MOTOR FAN COOLER – 치수

AFH - - - 430/2

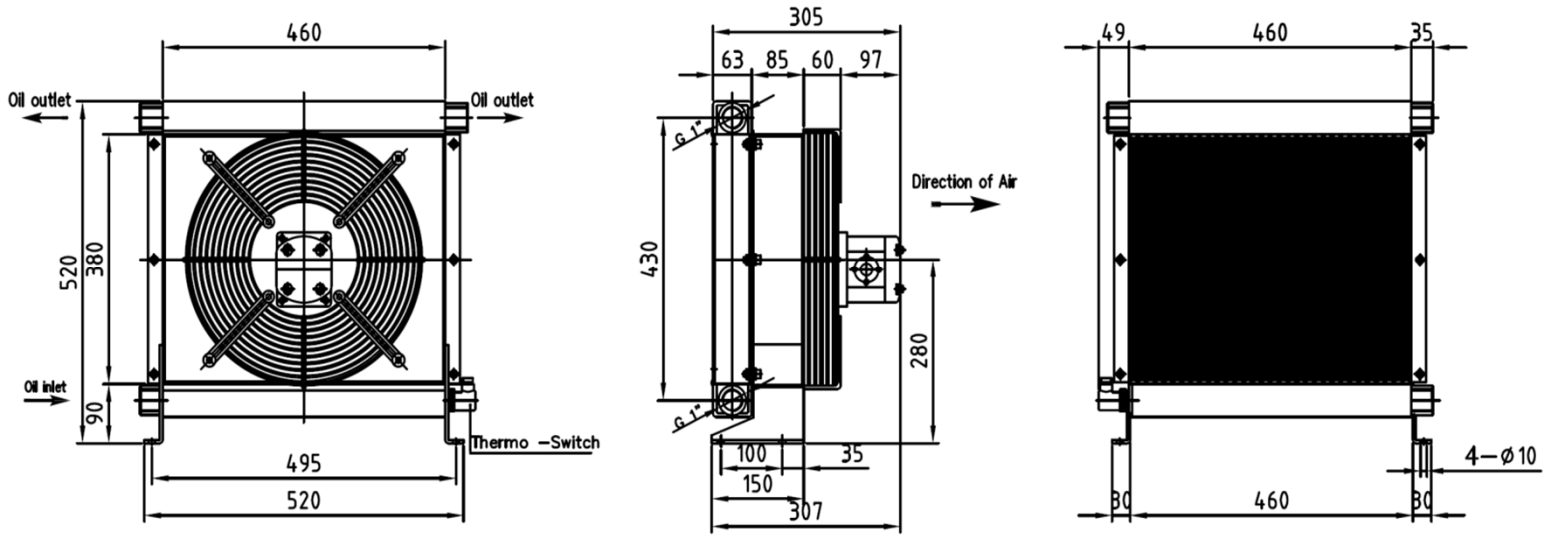

오일유량 OIL FLOW	오일체적 OIL CAPACITY	모터유량 MOTOR FLOW	토출유량 DISPLACEMENT	모터 POWER	풍량 AIR FLOW	회전수 RPM	소음정도 NOISE LEVEL	중량 WEIGHT	최대사용압력* PRESSURE RANGE*
l/min	l	LPM	cc/Rev	W	m <sup>3</sup> /hr	rpm	dB(A)	Kg	Bar
30 ~ 180	5.5	31	11.3	830	7,000	2,700	74	23	20

\* 최대사용압력은 동압 기준임.  
 \* Pressure range is based on dynamic pressure.

PERFORMANCE DIAGRAM  
 성능 곡선 표

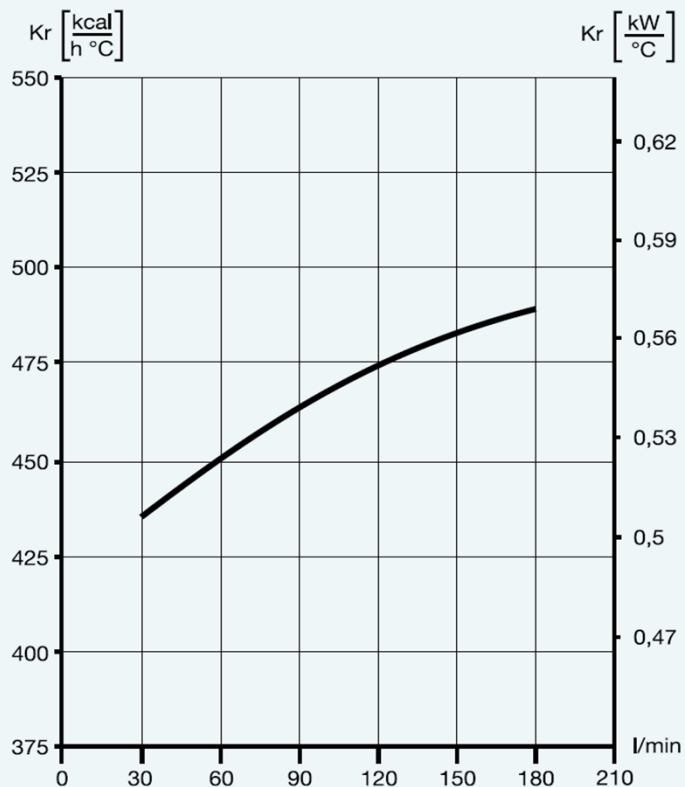

LOSS OF PRESSURE DIAGRAM  
 차압 곡선 표

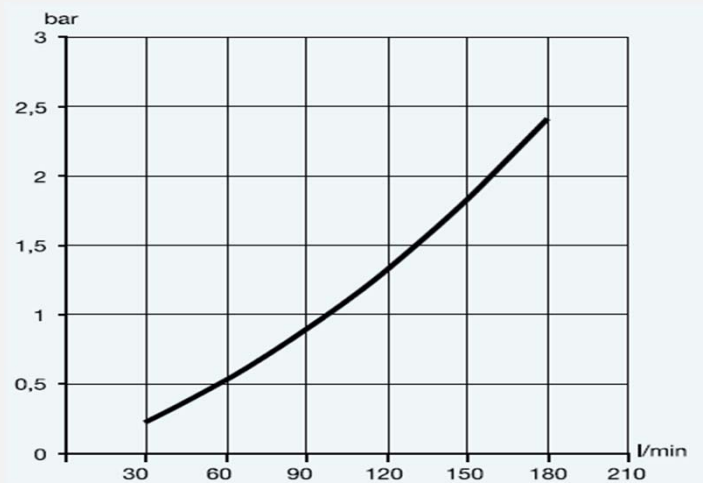

CORRECTION FACTOR  
 보정 계수

cSt	22	30	46	68	100	150	220
f	0.6	1	1.5	2.3	3.5	5	7



HYDRAULIC MOTOR FAN COOLER – DIMENSION  
 HYDRAULIC MOTOR FAN COOLER – 치수

AFH - - - 494

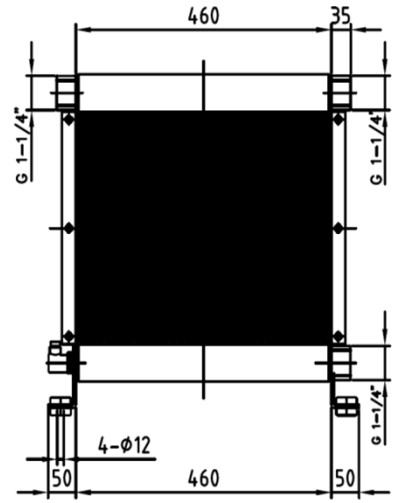
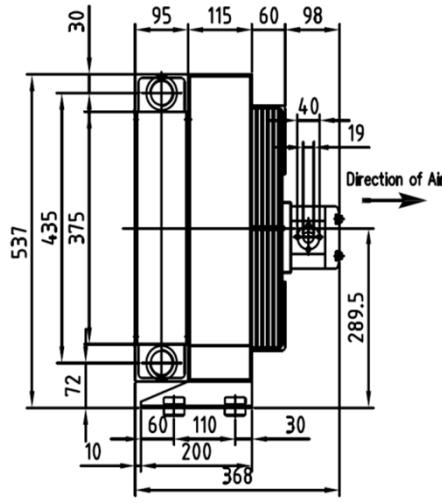
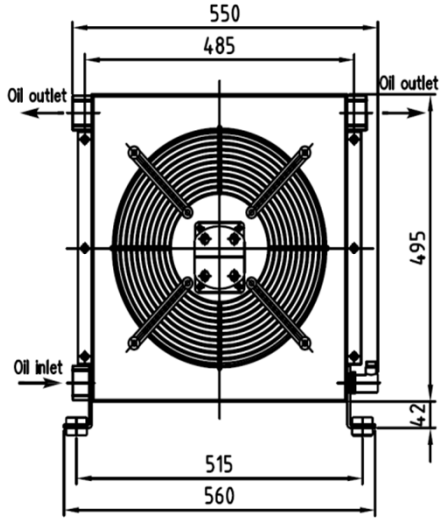

오일유량 OIL FLOW	오일체적 OIL CAPACITY	모터유량 MOTOR FLOW	토출유량 DISPLACEMENT	모터 POWER	풍량 AIR FLOW	회전수 RPM	소음정도 NOISE LEVEL	중량 WEIGHT	최대사용압력* PRESSURE RANGE*
l/min	l	LPM	cc/Rev	W	m <sup>3</sup> /hr	rpm	dB(A)	Kg	Bar
30 ~ 240	8	27	11.3	1100	8,000	2,400	75	26	20

\* 최대사용압력은 동압 기준임.  
 \* Pressure range is based on dynamic pressure.

PERFORMANCE DIAGRAM  
 성능 곡선 표

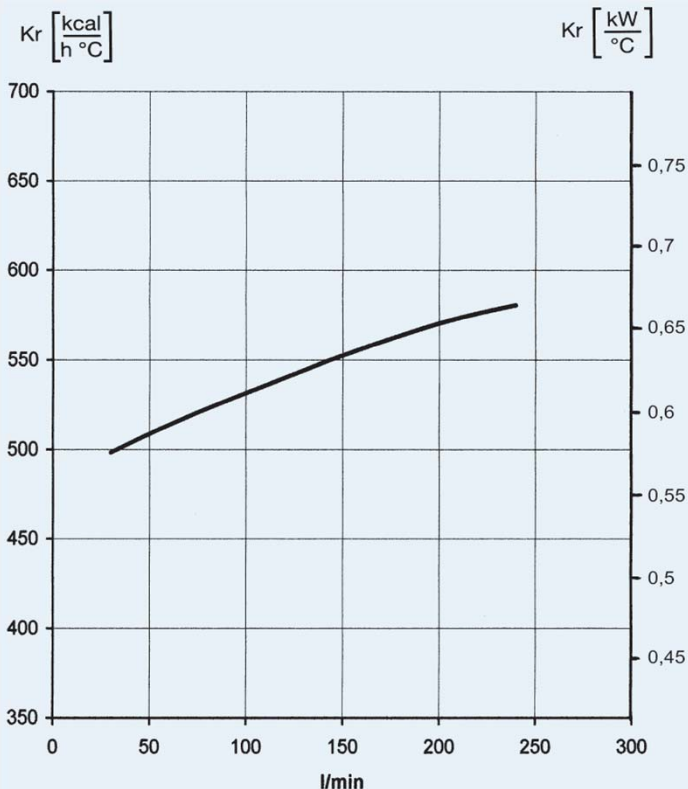

LOSS OF PRESSURE DIAGRAM  
 차압 곡선 표

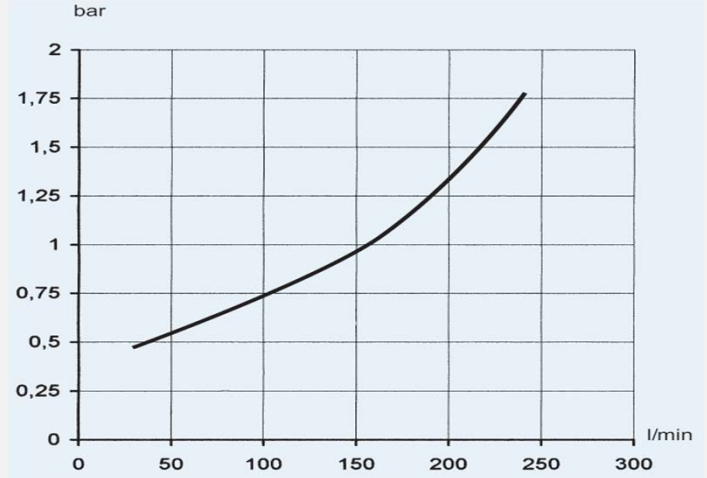

CORRECTION FACTOR  
 보정 계수

cSt	22	30	46	68	100	150	220
f	0.6	1	1.5	2.3	3.5	5	7

HYDRAULIC MOTOR FAN COOLER – DIMENSION  
 HYDRAULIC MOTOR FAN COOLER – 치수

AFH - - - 580

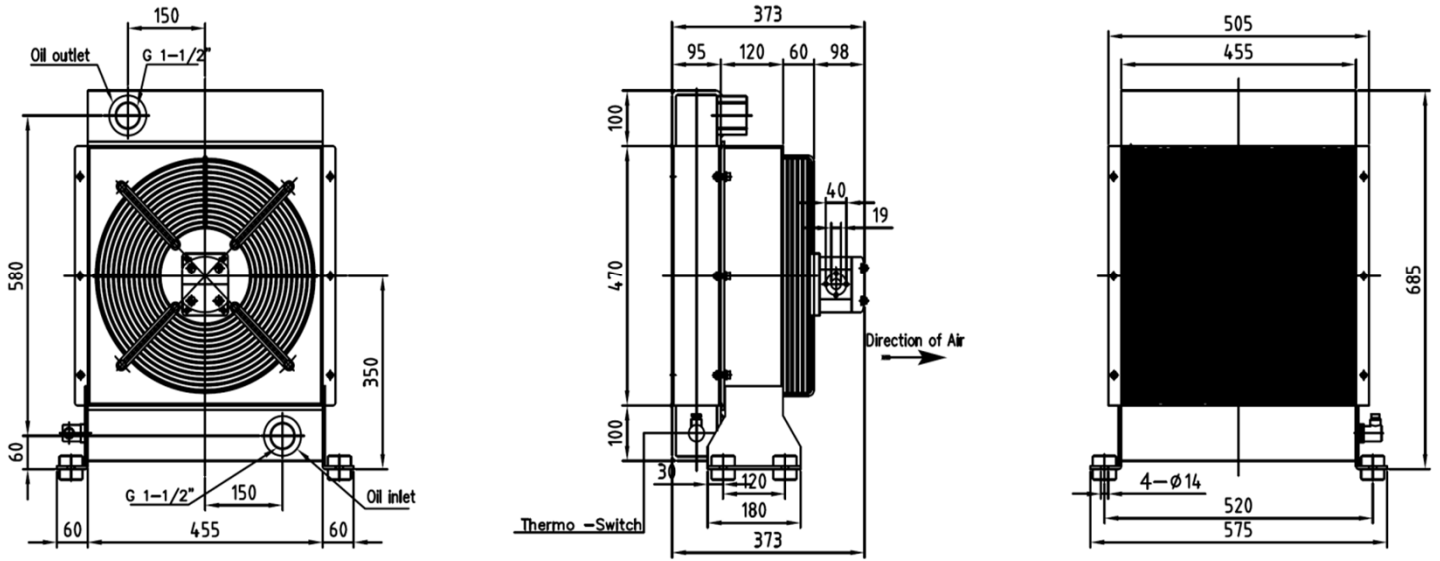

오일유량 OIL FLOW	오일체적 OIL CAPACITY	모터유량 MOTOR FLOW	토출유량 DISPLACEMENT	모터 POWER	풍량 AIR FLOW	회전수 RPM	소음정도 NOISE LEVEL	중량 WEIGHT	최대사용압력* PRESSURE RANGE*
l/min	l	LPM	cc/Rev	W	m <sup>3</sup> /hr	rpm	dB(A)	Kg	Bar
100 ~ 250	11.5	26	11.3	880	8,000	2,250	78	38	20

\* 최대사용압력은 동압 기준임.  
 \* Pressure range is based on dynamic pressure.

PERFORMANCE DIAGRAM  
 성능 곡선 표

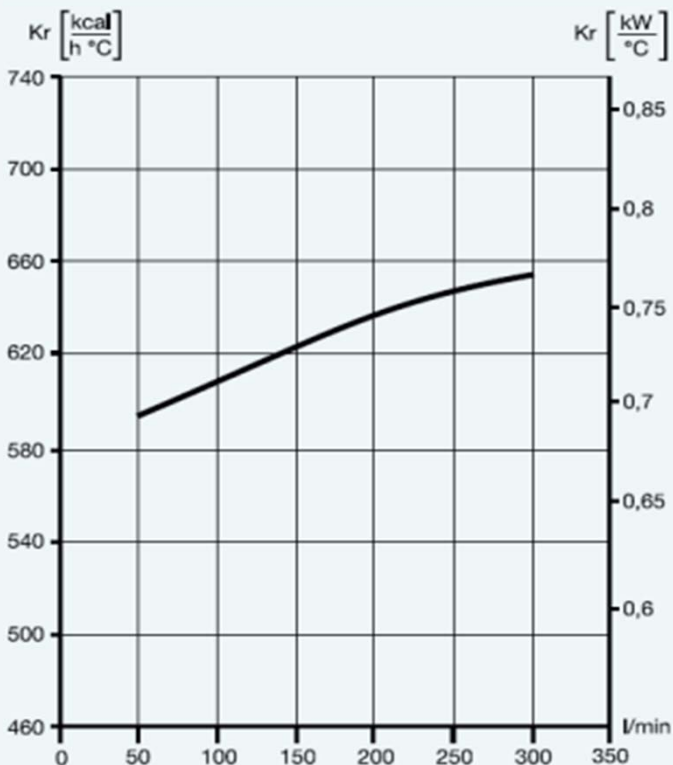

LOSS OF PRESSURE DIAGRAM  
 차압 곡선 표

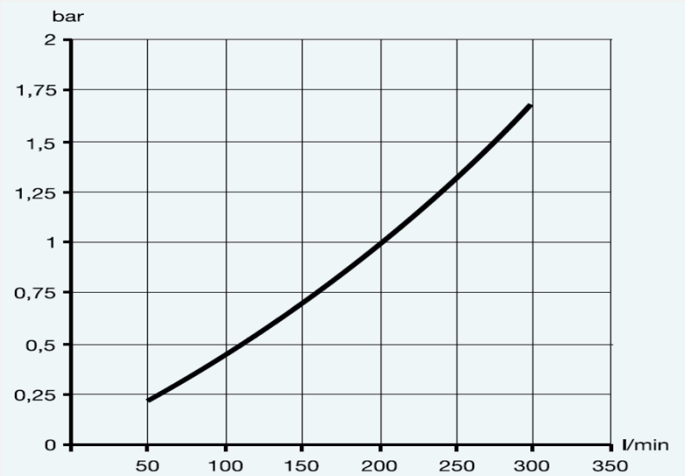

CORRECTION FACTOR  
 보정 계수

cSt	22	30	46	68	100	150	220
f	0.6	1	1.5	2.3	3.5	5	7

HYDRAULIC MOTOR FAN COOLER – DIMENSION  
 HYDRAULIC MOTOR FAN COOLER – 치수

AFH - - - 680

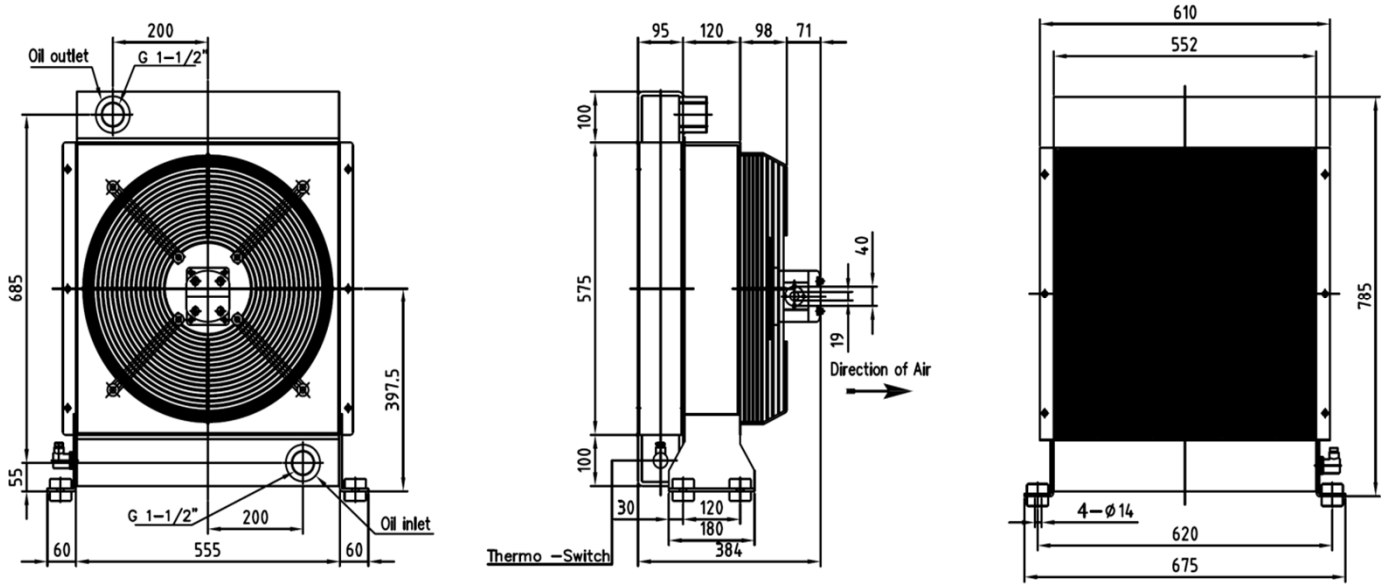

오일유량 OIL FLOW	오일체적 OIL CAPACITY	모터유량 MOTOR FLOW	토출유량 DISPLACEMENT	모터 POWER	풍량 AIR FLOW	회전수 RPM	소음정도 NOISE LEVEL	중량 WEIGHT	최대사용압력* PRESSURE RANGE*
l/min	l	LPM	cc/Rev	W	m <sup>3</sup> /hr	rpm	dB(A)	Kg	Bar
100 ~ 300	15	17	11.3	750	10,000	1,450	80	48	20

\* 최대사용압력은 동압 기준임.  
 \* Pressure range is based on dynamic pressure.

PERFORMANCE DIAGRAM  
 성능 곡선 표

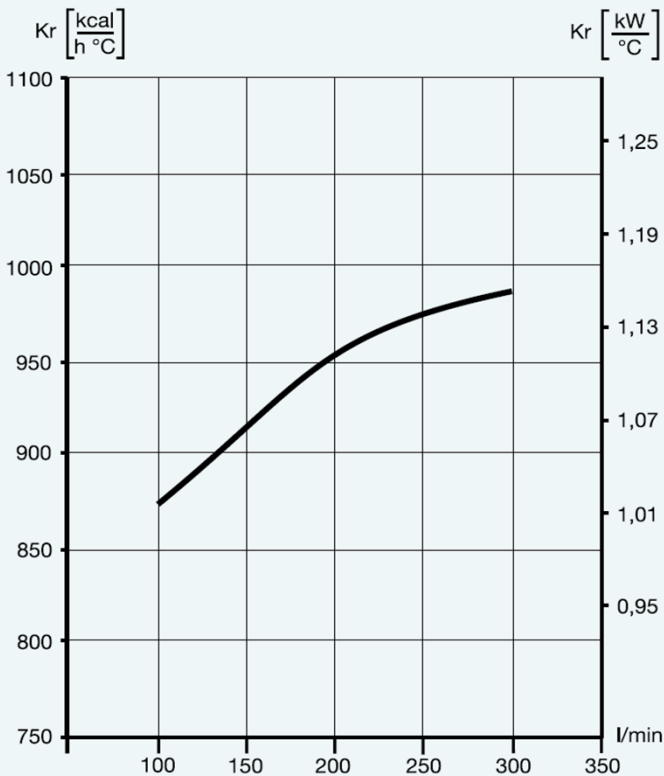

LOSS OF PRESSURE DIAGRAM  
 차압 곡선 표

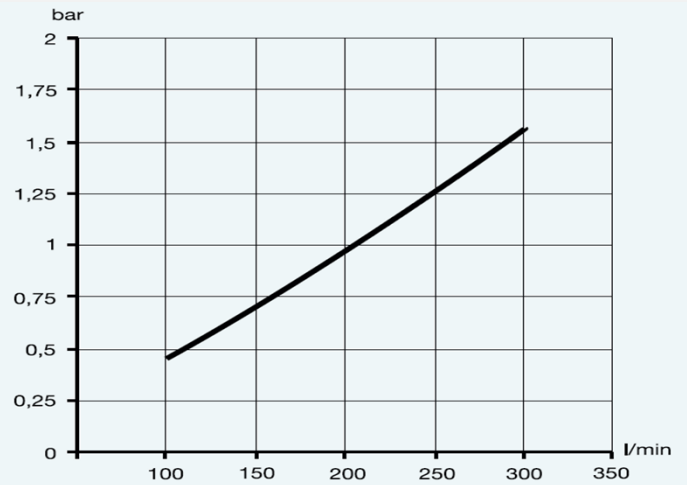

CORRECTION FACTOR  
 보정 계수

cSt	22	30	46	68	100	150	220
f	0.6	1	1.5	2.3	3.5	5	7

HYDRAULIC MOTOR FAN COOLER – DIMENSION  
 HYDRAULIC MOTOR FAN COOLER – 치수

AFH - - - 730

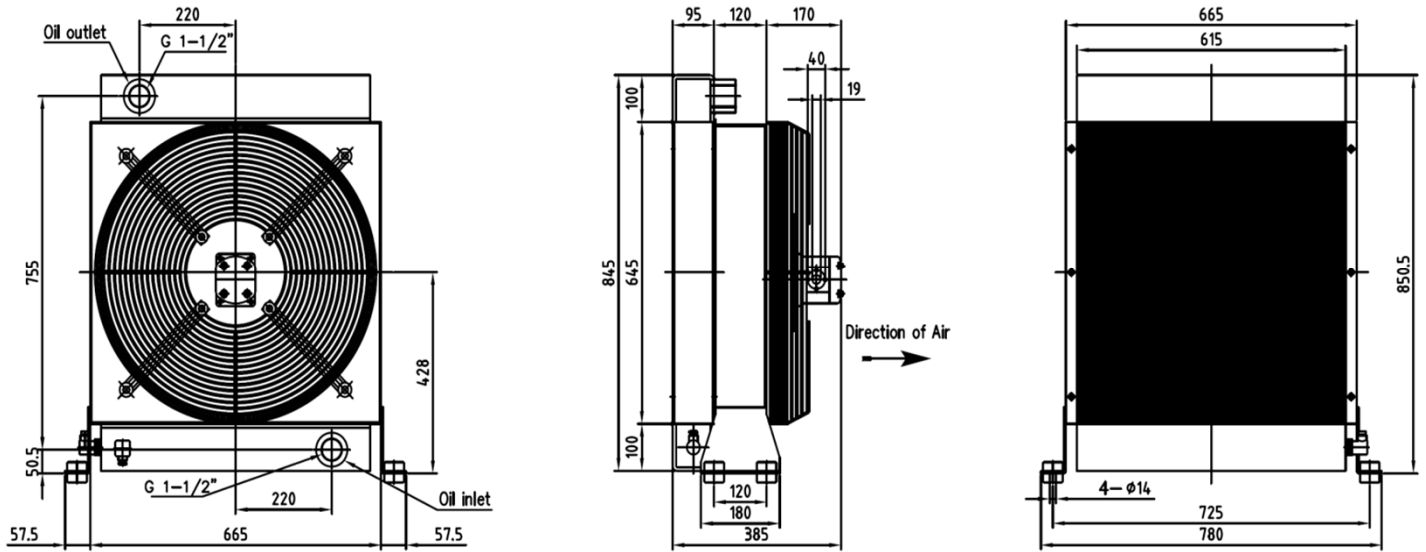

오일 유량 OIL FLOW	오일 체적 OIL CAPACITY	모터 유량 MOTOR FLOW	토출 유량 DISPLACEMENT	모터 POWER	풍량 AIR FLOW	회전수 RPM	소음 정도 NOISE LEVEL	중량 WEIGHT	최대 사용압력* PRESSURE RANGE*
l/min	l	LPM	cc/Rev	W	m <sup>3</sup> /hr	rpm	dB(A)	Kg	Bar
100 ~ 350	16	17	11.3	1,000	12,000	1,450	80	56	20

\* 최대 사용압력은 동압 기준임.  
 \* Pressure range is based on dynamic pressure.

PERFORMANCE DIAGRAM  
 성능 곡선 표

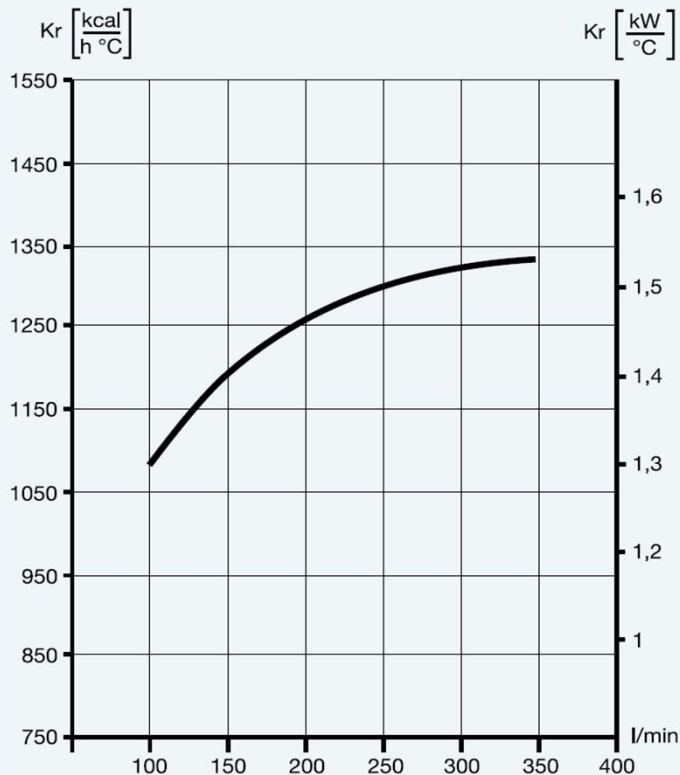

LOSS OF PRESSURE DIAGRAM  
 차압 곡선 표

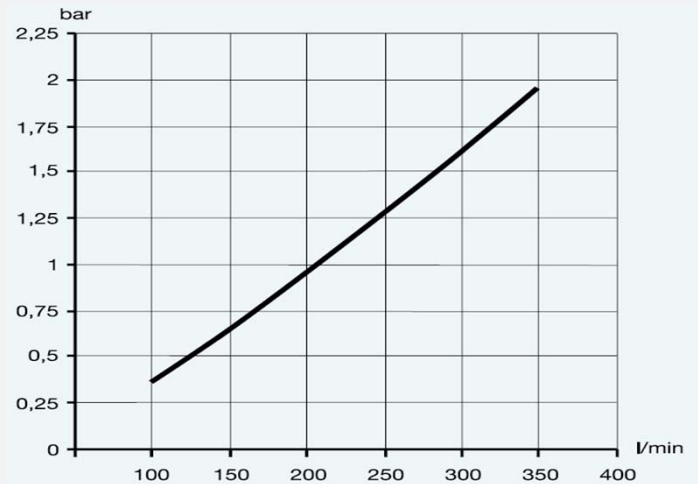

CORRECTION FACTOR  
 보정 계수

cSt	22	30	46	68	100	150	220
f	0.6	1	1.5	2.3	3.5	5	7

HYDRAULIC MOTOR FAN COOLER – DIMENSION  
 HYDRAULIC MOTOR FAN COOLER – 치수

AFH - - - 830

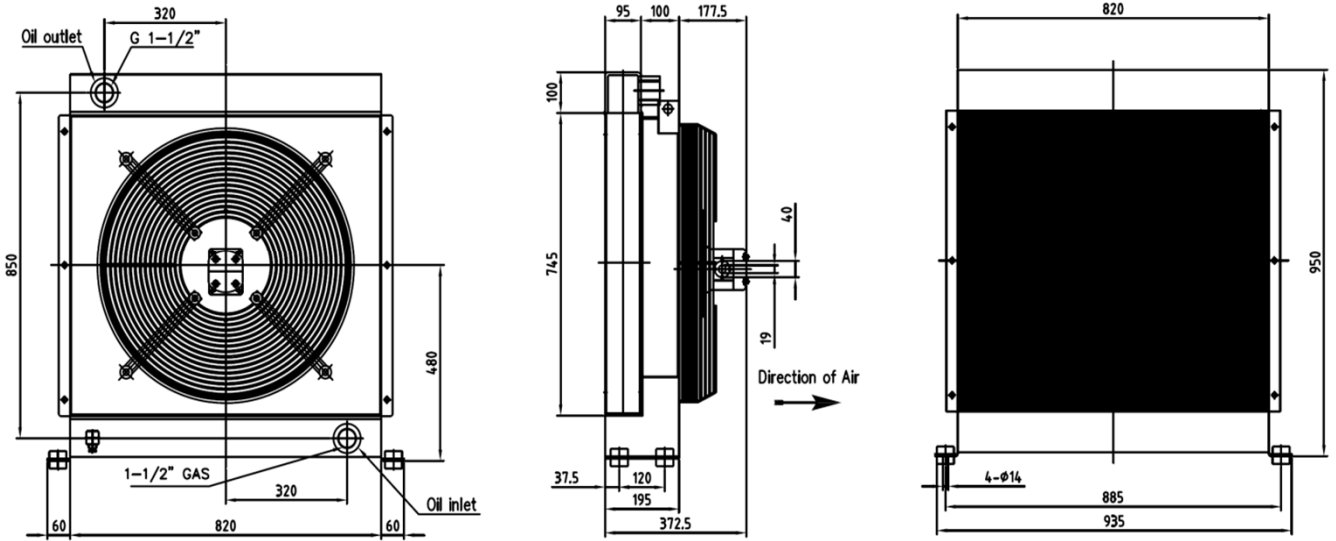

오일유량 OIL FLOW	오일체적 OIL CAPACITY	모터유량 MOTOR FLOW	토출유량 DISPLACEMENT	모터 POWER	풍량 AIR FLOW	회전수 RPM	소음 정도 NOISE LEVEL	중량 WEIGHT	최대사용압력* PRESSURE RANGE*
l/min	l	LPM	cc/Rev	W	m <sup>3</sup> /hr	rpm	dB(A)	Kg	Bar
150 ~ 400	20	23	11.3	1,300	15,000	1,300	82	75	20

\* 최대사용압력은 동압 기준임.  
 \* Pressure range is based on dynamic pressure.

PERFORMANCE DIAGRAM  
 성능 곡선 표

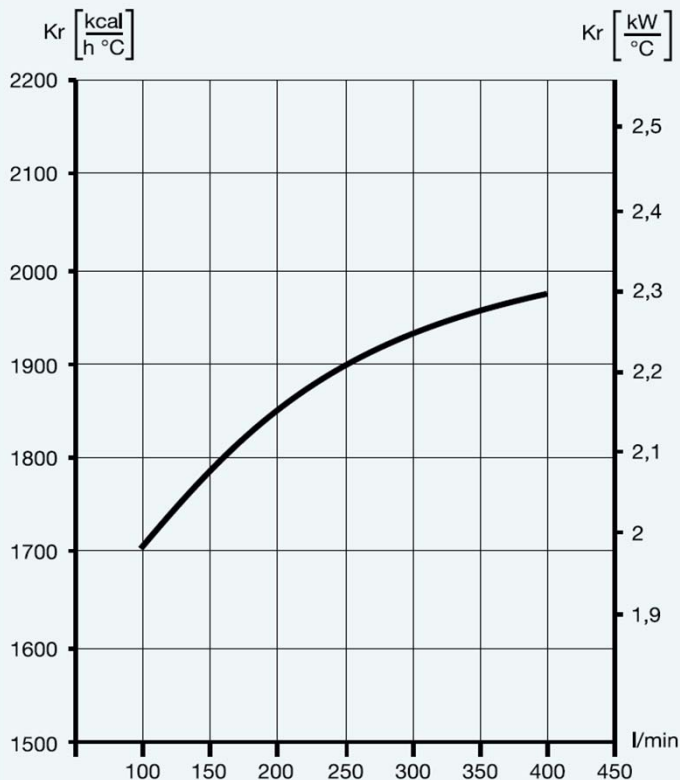

LOSS OF PRESSURE DIAGRAM  
 차압 곡선 표

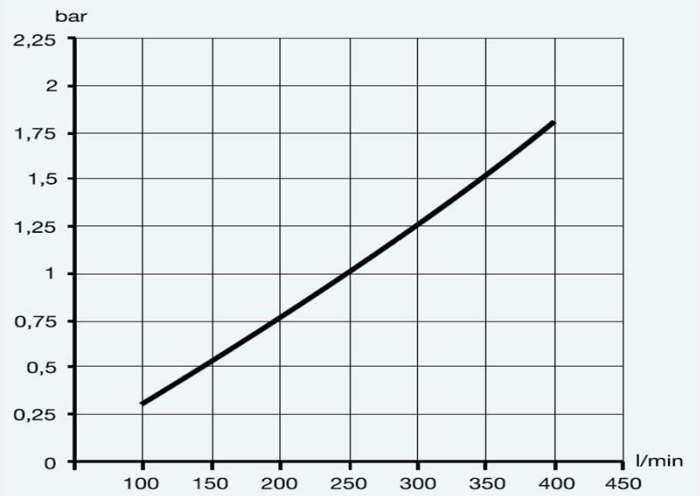

CORRECTION FACTOR  
 보정 계수

cSt	22	30	46	68	100	150	220
f	0.6	1	1.5	2.3	3.5	5	7

# Fluma Co., Ltd.



## 주식회사 플루마 Fluma Co., Ltd.

(우)50877 경상남도 김해시 주촌면 서부로1499번길22-60(주촌면)

Tel: 055-909-8129 Fax:055-909-8130

22-60, Seobu-ro 1499 beon-gil, Juchon-myeon,  
Gimhae-si, Gyeongsangnam -do, Rep. of Korea

### 영업

#### 심재문 대표

메일 : [jmshim@fluma.co.kr](mailto:jmshim@fluma.co.kr), [www.fluma.co.kr](http://www.fluma.co.kr)

전화 : +82 55 909 8129 / 팩스 : +82 55 909 8130

핸드폰 : +82 10 2561 8129

#### 정현성 이사

메일 : [hsjung@fluma.co.kr](mailto:hsjung@fluma.co.kr), [www.fluma.co.kr](http://www.fluma.co.kr)

전화 : +82 55 909 8129 / 팩스 : +82 55 909 8130

핸드폰 : +82 10 9525 6263

### Sales contact persons

Jae-mun, Shim / President,

E-mail : [jmshim@fluma.co.kr](mailto:jmshim@fluma.co.kr), [www.fluma.co.kr](http://www.fluma.co.kr)

Tel. : +82 55 909 8129 / Fax. : +82 55 909 8130

M.P : +82 10 2561 8129

Hyeon-sung, Jung / Director,

E-mail : [hsjung@fluma.co.kr](mailto:hsjung@fluma.co.kr), [www.fluma.co.kr](http://www.fluma.co.kr)

Tel. : +82 55 909 8129 / Fax. : +82 55 909 8130

M.P : +82 10 9525 6263